



ZINKO

Journal Jack with Toe

Model: ZHJ Series
Capacity: 6 ~ 25 Ton

Usage:

Used for various applications in nuclear power plants. Mechanical design makes these units a good choice in harsh environments where hydraulic power is not stable. The various industrial applications include: shipyards, manufacturing facilities and power generation facilities.



ZHJ-2513

Special Features:

1. All metal design allows unit to endure high working temperatures.
2. Mechanical operation allows very precise adjustments to load height as required.
3. Load holding threads mechanically lock the load at desired position.
4. Ratcheting handle operation in both the lift and lowering positions.
5. Available in 6 to 25 ton capacities.

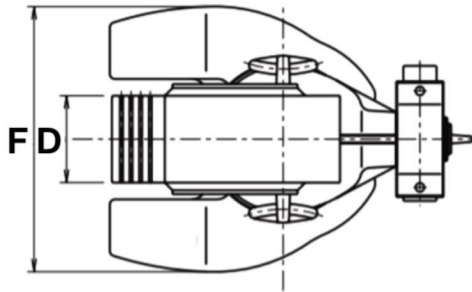
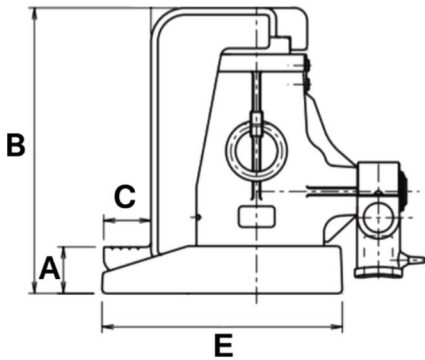

Model Number	Capacity (Ton)	Stroke (in)	Min. Height (in)		Max. Height (in)		Toe Length (in)	Toe Width (in)	Base Length (in)	Base Width (in)	Weight (lbs)
			Toe - A	Head - B	Toe	Head	C	D	E	F	
ZHJ-0615	6	6	1.18	12.20	7.18	18.20	1.77	2.75	8.19	7.28	51
ZHJ-1013	10	5	1.57	11.42	6.57	16.42	1.96	2.95	8.94	8.27	64
ZHJ-1513	15	5	1.77	11.69	6.77	16.69	1.96	3.15	9.53	9.06	84
ZHJ-2513	25	5	2.16	13.07	7.16	18.07	2.16	3.54	11.02	10.83	133