

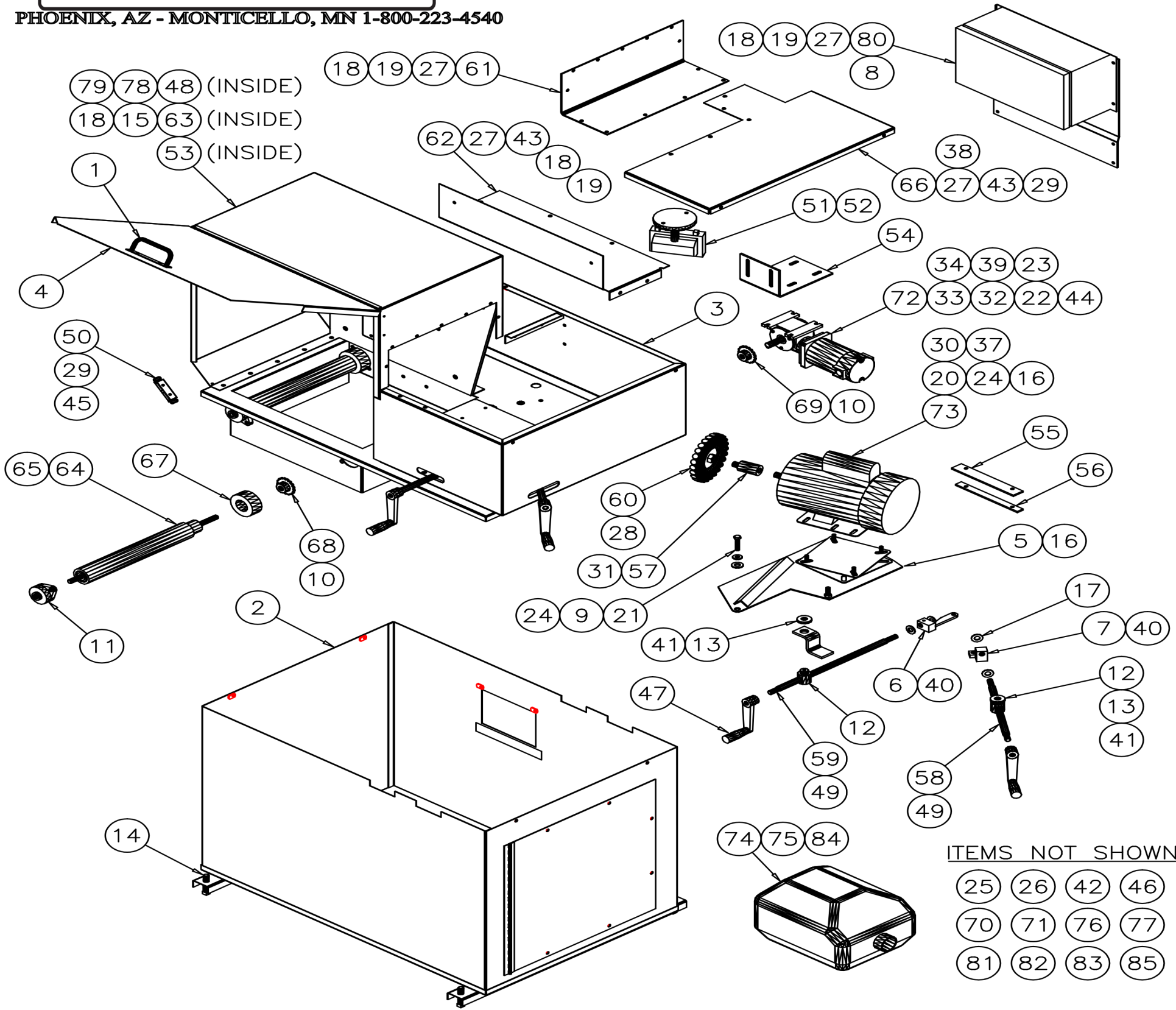

**TIRE SERVICE INTERNATIONAL**

PHOENIX, AZ - MONTICELLO, MN 1-800-223-4540

WC-15  
 WHEEL CLEANER  
 MAIN ASSEMBLY  
 BEGINNING SERIAL NO. XXXX  
 03-23-09



ITEMS NOT SHOWN

- |    |    |    |    |
|----|----|----|----|
| 25 | 26 | 42 | 46 |
| 70 | 71 | 76 | 77 |
| 81 | 82 | 83 | 85 |

# WHEEL CLEANER SMALL



## WC-15

REPAIR PARTS BOM

Page 1 of 2

PN: 0000

BEGINNING SERIAL NO.0000

3/23/2009

### PARTS LIST

ITEM	PART NO.	DESCRIPTION	QTY
1	6184K	DOOR HANDLE W/HDWR	1
2	6193	BASE WELD	1
3	6194	MAIN FRAME WELD	1
4	6195	SAFETY HOOD WELD	1
5	6196	ROTATE PLATE WELD	1
6	6197	PIVOT ANCHOR	1
7	6200	TRUNION, PIVOT	1
8	6204	CONTROL BOX PACKAGE	1
9	5.108	WASHER, EXTERNAL STAR	1
10	33.251	KEY SQ. 1/8 X 3/4	3
11	75.107	FLANGE BEARING, 1/2 BORE	4
12	128.055	CROSSFEED NUT	2
13	129.055	RETAINING NUT	2
14	218.028	SQ HD SET SCREW 1/2-13 X 2-1/2	4
15	387.028	FHCS 1/4-20 X 1-1/2 LG	6
16	212	NUT 3/8-16 SELF LOCK	13
17	224	WASHER 1/2 FLAT WROUGHT	4
18	226	NUT 1/4-20 NYLOK	20
19	445	WASHER 1/4 FLAT WROUGHT	29
20	446	HHCS 3/8-16 X 1-3/4	5
21	447	HHCS 3/8-16 X 1-1/4	9
22	565	HHCS 5/16-18 X 1.0	12
23	566	NUT 5/16-18 NYLOK	24
24	700	WASHER 3/8 FLAT WROUGHT	10
25	804	WIRE NUT #74 YELLOW	3
26	805	FL SP TERM 8-10 STUD 12-10 WIRE	1
27	903	HHCS 1/4-20 X .75	27
28	978	NUT 5/8-11 THIN	2
29	1055	SELF-TAPPER, HX HD 10-24 X 1/2	15
30	1204	FL SP TERM 8-10 STUD 16-14 WIRE	1

### PARTS LIST

ITEM	PART NO.	DESCRIPTION	QTY
31	1308	SHSS 3/8-16 X 5/16 LG	4
32	1318	WASHER 5/16 FLAT WROUGHT	12
33	1320	HHCS 5/16-18 X 1-1/2	4
34	1630	WASHER 5/16 SPRING LOCK	8
35	1737	HHCS 5/16-18 X 3/4	4
36	3031	DECAL - WARNING	2
37	3085	HHCS 1/4-20 X 1-3/4	2
38	3468	TRIM STRIP	AR
39	3478	HHCS 5/16-18 X 1-1/4	2
40	3501	GREASE FITTING 1/8NPT	2
41	3776	FHCS 1/4-20 X 3/4	2
42	3921	FITTING 1-1/4 NPT	1
43	4134	WASHER 1/4 SPRING LOCK	10
44	4267	CORD, 14/3	1
45	4570	NUT 10-24 NYLOK	15
46	4782	DECAL - SAFETY GLASSES	1
47	4954	CRANK, HANDLE	2
48	10535	SWITCH, ROLLER	1
49	10781	ROLL PIN 1/8 X 5/8	2
50	12151	MAGNET - DOUBLE	1
51	12170	LIGHT, 150 WATT HALOGEN FLOOD	1
52	12170-1	BULB, HALOGEN 150 WATT T-3	REF
53	12178	SIDE, ROLLER MTG	1
54	12179	MOUNT, GEAR MOTOR	1
55	12185	MOUNT, HOLD DOWN	1
56	12186	MOUNT, SPACER	1
57	12189	COUPLER, BRUSH MOUNT	1
58	12196	DRIVE SCREW, ROTATE	1
59	12197	DRIVE SCREW, SWIVEL	1
60	12198	BRUSH, WIRE WHEEL, TWISTED	2



# WHEEL CLEANER SMALL

## WC-15

REPAIR PARTS BOM

Page 2 of 2

PN: 0000

BEGINNING SERIAL NO.0000

3/23/2009

TIRE SERVICE INTERNATIONAL

### PARTS LIST

ITEM	PART NO.	DESCRIPTION	QTY
61	12199	WINDOW, SP.	1
62	12202	PANEL, BACKING	1
63	12203K	PLATE, WHEEL PROTECTING W/HDWR	1
64	12207	DRIVE ROLLER	2
65	12208	DRIVE ROLLER, RUBBER COATED	2
66	12209	COVER, MOTOR ACCESS	1
67	12236	SPACER GUIDE, ROLLER	2
68	12237	SPROCKET (#35) 1/2 BORE, 17 TEETH	2
69	12238	9 - TOOTH SPROCKET	1
70	12239	CHAIN, ROLLER, #35 PITCH (L = 37.15")	1
71	12240	CHAIN, CONN. LINK & OFFSET	1
72	12241	ELEC. MOTOR (GEAR)	1
73	12242	MOTOR, SINGLE PHASE, 2 HP, 3450 RPM	1
74	12243	VACUUM - COMPLETE W/CANISTER	1
75	12243-1	VACUUM - FILTER	REF
76	12246	DECAL - WC-15 TSI PRODUCT	2
77	12247	DECAL - ELEC POWER REQUIRED	1
78	12251	ELEC BOX, SINGLE - PLASTIC, HANDY	1
79	12252	ELEC BOX COVER, SINGLE, PLASTIC	1
80	12253	MOUNTING PLATE, CONTROL BOX	1
81	12255	STRAIN RELIEF 1/2 NPT - PLASTIC	3
82	12256	STRAIN RELIEF 3/4 NPT - PLASTIC	1
83		MADE IN USA	1
84		VELCRO STRIPS, 6"	2
85		WIRE NUT - ORANGE	4
86			
87			
88			
89			
90			

### PARTS LIST

ITEM	PART NO.	DESCRIPTION	QTY
91			
92			
93			
94			
95			
96			
97			
98			
99			
100			
101			
102			
103			
104			
105			
106			
107			
108			
109			
110			
111			
112			
113			
114			
115			
116			
117			
118			
119			
120			