

ITRIP250092G

EN: TRANSLATION OF THE ORIGINAL INSTRUCTIONS



O.ME.R. S.p.A.
Via Galileo Galilei, 20
30035 MIRANO (VENEZIA) Italy
Tel.+39 041.5700303
Fax +39 041.5700273
Numero verde 800 017745
E-Mail: info@omerlift.com
www.omerlift.com

TRIPARK 25

Capacity 2500 Kg for each platform

Noise emission 70dB(A)

INSTALLATION MANUAL

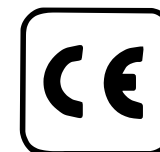
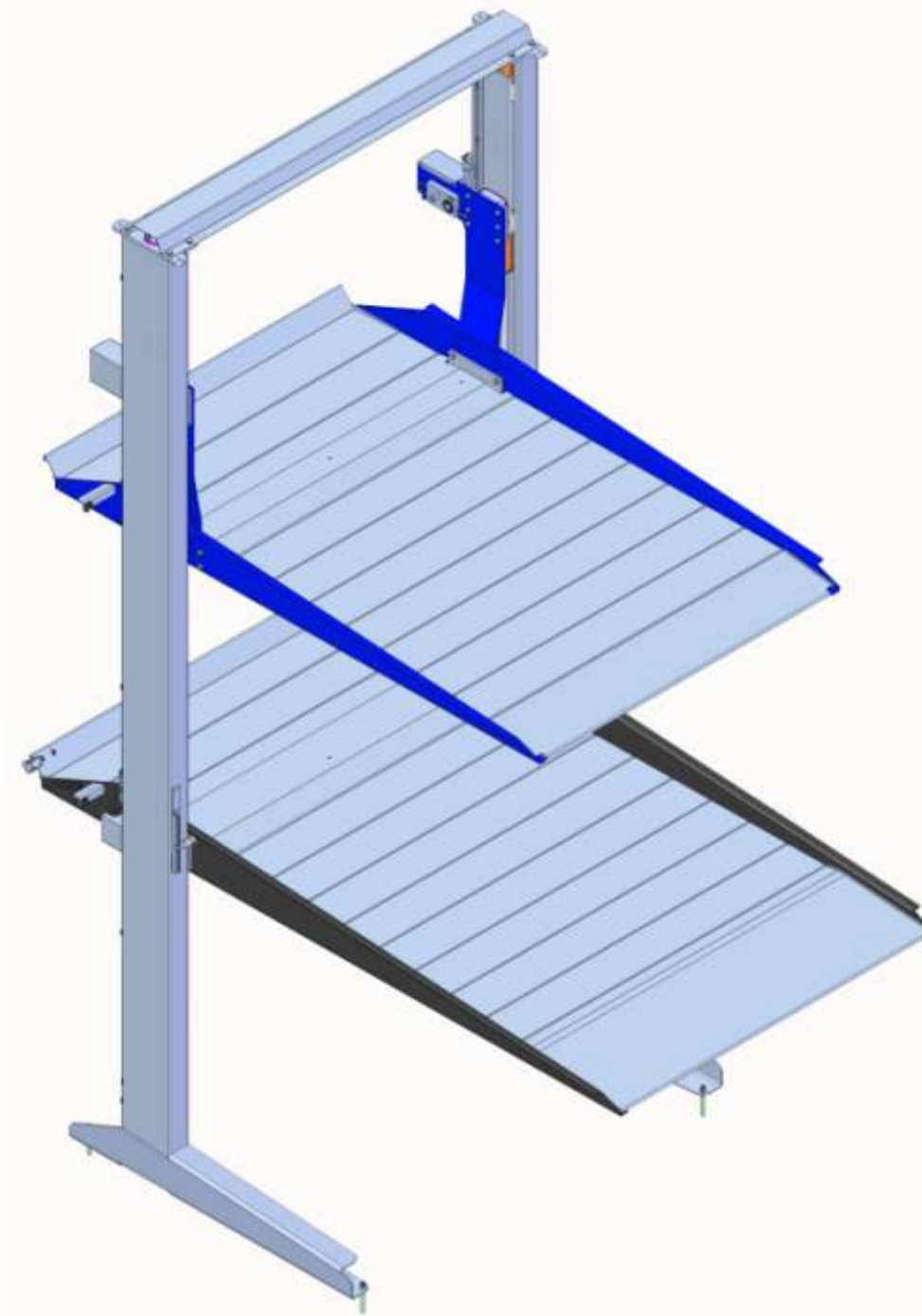

INDEX





ENGLISH

1. SYMBOLS USED IN THE MANUAL	3
2. INTRODUCTION.....	4
3. SCOPE AND CONTENT.....	4
4. SAFETY	5
4.1. SAFETY SIGNAGE	5
5. PREPARATION OF THE YARD.....	5
5.1. WORK TO BE PERFORMED BEFORE STARTING INSTALLATION.....	5
5.2. BUILDING SCAFFOLDING	6
6. EQUIPMENT	6
7. TRANSPORT AND HANDLING	7
7.1. WEIGHT AND DIMENSIONS OF THE PACKAGED LIFT.....	8
8. PLACE OF INSTALLATION.....	9
8.1. SHAFT.....	9
8.2. ELECTRIC SUPPLY SYSTEM.....	10
8.2.1. <i>Connection Instructions</i>	10
9. INSTALLATION PROCEDURE.....	11
Column	11
STOP microswitches(FC2SX,FC2DX).....	13
9.1. LEVELLING THE LIFT STRUCTURE	15
Lower platform guides.....	17
Central lower cross brace	18
Torsion bar.....	19
Upper platform guides.....	21
Upper central cross brace.....	22
Magnet check microswitch (FCSX e FCDX).....	25
Magnets (M2)	25
STOP microswitch (FC11).....	27
BYPASS microswitch (FCBY2)	28
Photocell (FOT) and reflector (CAT) (<i>OPTIONAL</i>).....	29
9.2. WIRING CONNECTIONS.....	31
9.3. HYDRAULIC CONNECTIONS	33
9.3.1. <i>Connection of hydraulic unions</i>	34
9.4. LEVELLING THE COMPLETE STACKER	35
Ground anchoring.....	36

9.5. INSTALLING CHEMICAL ANCHORS	37
Covers.....	38
10. CHECK BEFORE USING.....	43
10.1. FINAL TESTING	43
10.2. HANDING OVER THE PLATFORM.....	43
11. DISMANTLING THE MACHINE.....	44

1. Symbols used in the manual

The signage (ISO) indicated below is used within this manual to focus attention on those operations that must be performed carefully in order to guarantee safety during installation.

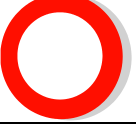
	GENERAL DANGER	Indicates that, when performing the operation, great care must be taken to prevent the onset of events that could cause serious injury or damage.
	ELECTRICAL DANGER	Indicates that, when performing the operation, an event (of an electrical nature) could arise leading to injury or damage.
	DANGER OF PINCHING	Indicates that, during installation or transport of system components, suitable lift equipment must be used and utmost attention applied.
	DANGER OF FALLING	Indicates that, during installation, the operator crosses zones where there is high risk of falling; always be particularly careful.
	IMPORTANT	Indicates that the indications or instructions described in the text must be followed to the letter. Non-compliance with the indications can be dangerous for the operator and can damage the system.
	PROHIBITION	Indicates that the specific activity or operating sequence must be avoided

2. Introduction

Target:

- OPERATORS/SKILLED TECHNICIANS.



Before starting installation, always check that:

- the installation site has the required characteristics
- the necessary utilities are available
- adequate guards have been installed

as described in the chapter "Safety - Customer requirements" in the User's Manual.

The platform complies with the certification issued by O.M.E.R. only if the installation site meets the indicated requirements.

3. Scope and content

This manual describes the operations needed to install and start up the triple car stacker system.

During the various phases of activity, the installer must follow all national standards regarding safety in the workplace.

If particular situations not described in this manual are encountered, interrupt the work and notify the manufacturer.

4. Safety

Before starting installation, make certain that all necessary P.P.E. (personal protection equipment) is available. We recommend using the P.P.E. required by current law.

4.1. Safety signage

Below is an indication of the yard standard safety signage

	WORK GLOVES	Must always be worn while in the yard.
	SAFETY SHOES	Must always be worn while in the yard.
	SAFETY HARNESS	Must always be worn when working inside the shaft and on scaffolding higher than 2 m.
	HELMET WITH CHIN STRAP	Must always be worn while in the yard.
	EAR PROTECTION	Must always be worn while using noisy equipment.
	SAFETY GOGGLES/GLASSES	Must always be worn while in the yard.

5. Preparation of the yard



5.1. Work to be performed before starting installation

Before starting installation, perform the following operations:

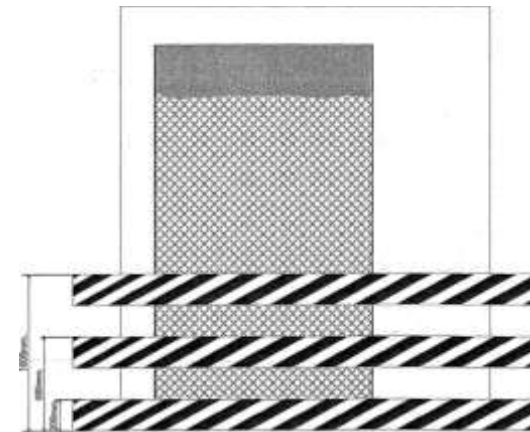
- 1 Check that the safety guards are properly installed on all doors at all floors, as indicated in the drawing below, and that the pertinent danger signs have been posted.
- 2 Check availability of an electrical power supply line with ground and protected upstream by a magnetothermal differential switch set to cut in at 30mA in compliance with CEI 64/8





5.2. Building scaffolding

	<p>WARNING:</p>	<p>The scaffoldings must be built in compliance with the following decrees:</p> <p>-It. Pres. Decree 164/1956;</p> <p>-It. Pres. Decree 547/1955;</p>
	<p>IMPORTANT:</p>	<p>The supervisor must also check that the shaft complies with the available drawings.</p>

6. Equipment

In addition to the standard equipment, the following are required for installation:

	<p>SERIES OF SOCKET WRENCHES</p>
	<p>SERIES OF FLAT AND PHILIPS-HEAD SCREWDRIVERS</p>
	<p>OIL PIPE WRENCHES</p>

	<p>PIN DRIVE. MASON'S PENCILS. PLUMB LINE WITH MAGNET. METER</p>
	<p>STEEL SAW</p>
	<p>No. 3 SAFETY CHAINS CERTIFIED FOR 2000 KG.</p>
	<p>TIRFOR WINCH RATED 1500 kg. WITH CABLE AND ACTUATING LEVER</p>
	<p>INSULATED PLIERS. INSULATED SCISSORS. HAMMER</p>
	<p>SPIRIT LEVEL</p>
	<p>DRILL</p>
	<p>GRINDER</p>

7. Transport and handling

- The lift is wrapped in nylon..
- It must be transported with special equipment rated to handle weights higher than that of the part being moved.

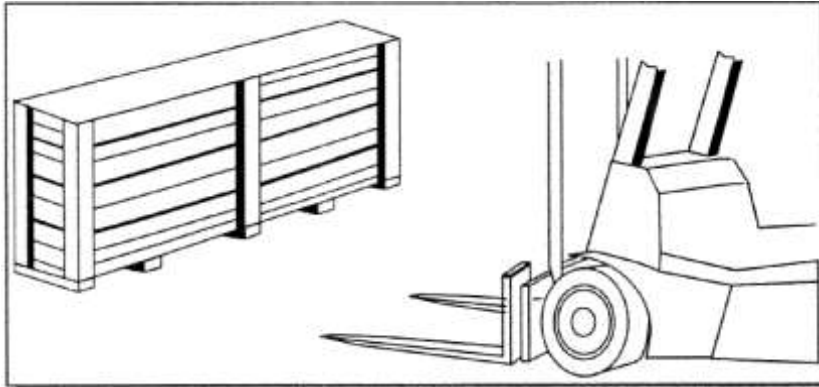

When a wooden create is not used, the unit is packaged in plasticized Pluriboll sheet to protect the components.

FOLLOW THE INSTRUCTIONS BELOW:

- protect the electrical control box from the weather.
- protect the electrical box from impacts.
- protect the corners and ends of the piece being transported with suitable material (Pluriboll – cardboard).
- harness the unit to the lifting points using special slings

7.1. *Weight and dimensions of the packaged lift*

DESCRIPTION		No. OF PACKAGES	Length (mm)	Width (mm)	Height (mm)	Weight (kg)
A	COLUMNS + SHOULDER + CILINDER	1	5900	600	2000	1200
B	PLATFORM CONNECTION SHOULDER + TORSION BAR + UPPER OMEGA CONNECTION	1	2700	800	500	400
C	SLATS - UPPER PLATFORM	1	2100	600	300	150
D	SLATS - LOWER PLATFORM	1	2200	600	300	150
E	LOWER SHOULDER PLATFORM	1	3500	200	400	150
F	UPPER SHOULDER PLATFORM	1	4200	300	1100	250
G	CONTROL UNIT + ELECTRIC BOX + PUSH BUTTON PANEL	1	500	300	750	50
H	SCREWS + REGULATIONS' NOTICEBOARD + DOCUMENTS + CABLE (MICRO)	1	600	400	400	50
TOT		8				2400

The packages can vary depending on:

- size of the lift
- type of shipment
- package used, according to customer request
- country of shipment.



FOR TRANSPORT, THE CAGE (OR PACKAGED LIFT) MUST BE ADEQUATELY SECURED TO PREVENT IT FROM SHIFTING ON THE DECK OF THE TRANSPORT VEHICLE.

8. Place of installation

8.1. Shaft

Choose an adequate installation site large enough to suit the size of the lift and the chosen hoisting equipment.

The installation site must be fitted with all the plant connections needed to start up the lift.

MAX PRESSURE ON THE FOUNDATION PLATE	Kg/cm ²	≤ 1
	PROVIDE WATER DRAINAGE AND IMMERSION PUMP	

To install the anchor capsules, the foundation must have the following characteristics:

FOUNDATION	Tamped
THICKNESS OF CONCRETE	≥ 20 cm
CONCRETE RESISTANCE CLASS	≥ C 25
IMPROVED ADHERENCE STEEL GIRDERS	Type FeB 44 K
REINFORCEMENT GIRDERS FOR LARGE SURFACES	Electrowelded mesh
REINFORCEMENT GIRDERS FOR SMALL SURFACES	Bent irons
FLATNESS	± 1 / 1000



WORKING TEMPERATURE:
DA -10 A + 40 ° C.

When the floor characteristics are not available, a suitable foundation has to be done below the supporting plates of the platform.

The lift must in any case be fastened to the floor using dedicated chemical anchor capsules.

8.2. Electric supply system

The electric supply system must include:

- a general switch with padlockable circuit breaker;
- fuses or thermal magnet protection suited to the machine's characteristics;
- device for protection against accidental contact.

The switch must be positioned in the immediate vicinity of the machine in compliance with local accident prevention regulations.

Power cables must have a suitable section for absorbing current, without deviations for other utilities.

Electric systems must be created according to the state of the art by a qualified electrician who will check the earthing system's efficiency.

The power cable must be locked in the dedicated cable gland and the electric panel must be carefully closed to assure the envisaged IP 54 protection.

Only connect the machine to type approved sockets with an earth cable of proven efficiency.

Periodically have qualified personnel check the correct tightening of the electric cables of the various components.

8.2.1. Connection Instructions



The supply electrical cable comply with the standard and is made by four wires of adequate section.

Attention:

- power the lift's electrics system using a line fitted with a mains switch and without any other junctions.
- The devices fitted to provide protection against short circuits must take into account the features of the electrical equipment:

NOMINAL POWER		kW	2,5	2,5	2,2	2,6
VOLTAGE		V	230	400	208-220	208
No. of phases			3	3	1	3
FREQUENCY		Hz	50	50	60	60
NOMINAL CURRENT		A	13	6,4	23	13,5
PICKUP CURRENT		A	91	35,8	126	50
PROTECTION	FUSE (DELAYED)	A	20	10	32	25
	FUSE (FAST)	A	25	20	40	32
	THERMOMAGNET	A	25	25	32	25
CABLE SECTION		mm ²	2.5	2.5	6	2.5

9. Installation procedure

Column

Position the columns on ground.

Fix:

	TYPE	Q.ty	Torque Nm
SCREW	M16x30	8	198
WASHER	M16	16	/
NUT	M16	8	/

1

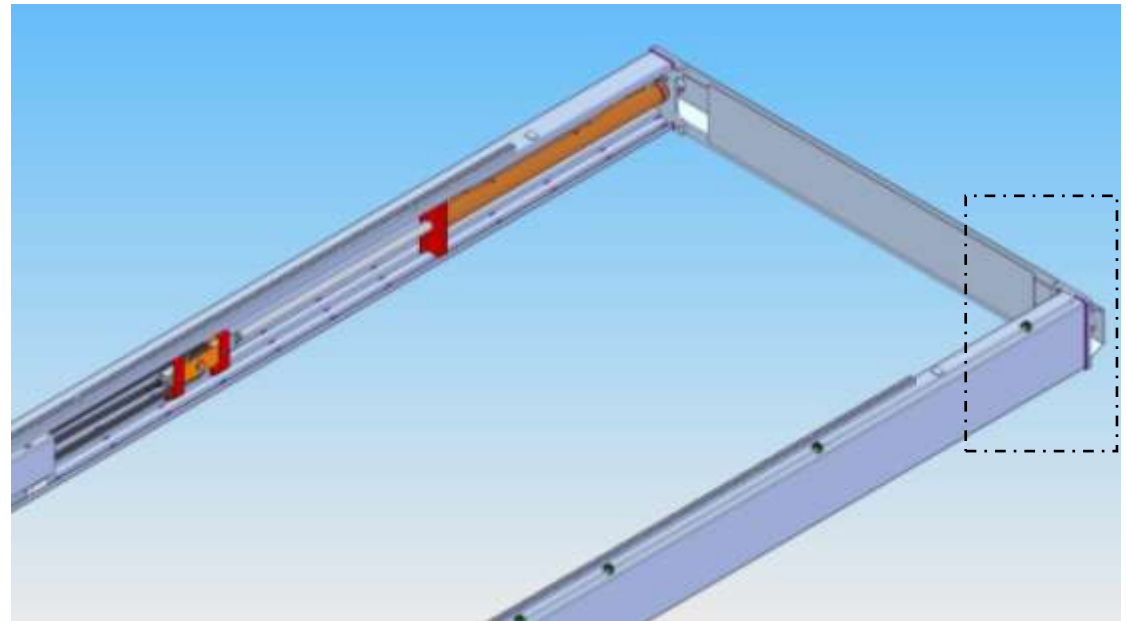
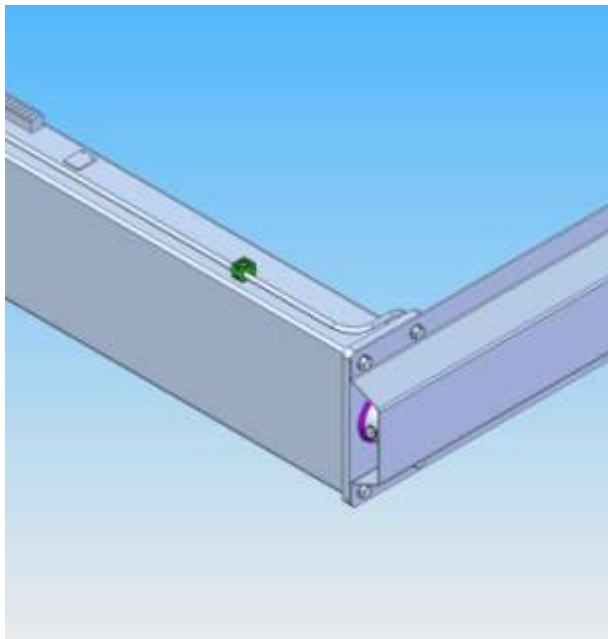

Fix pipes + joints.

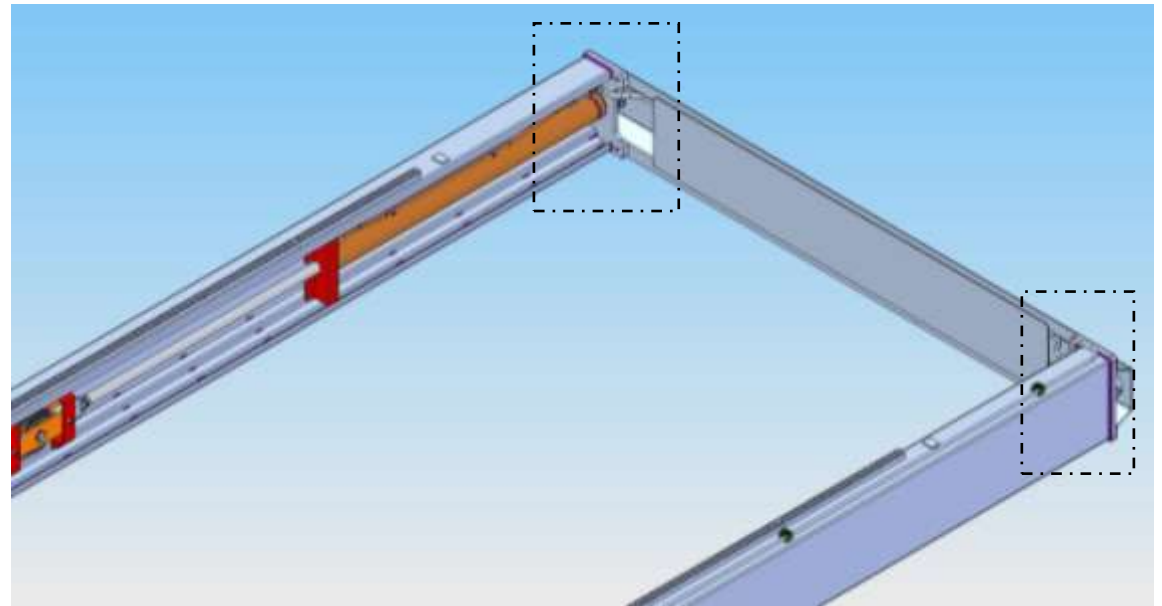
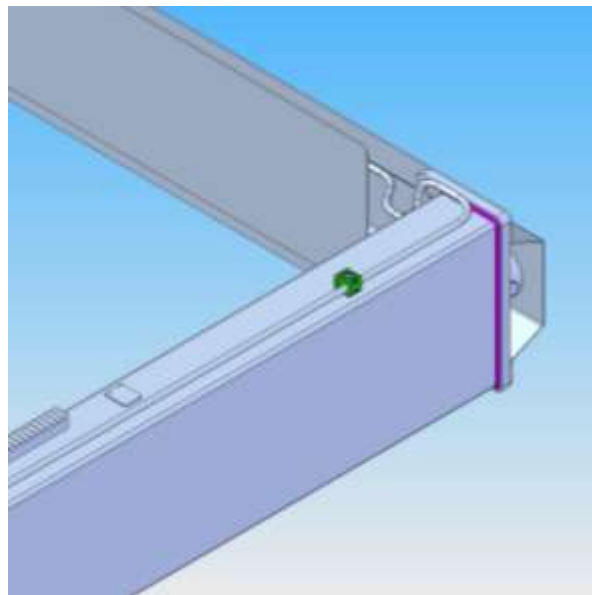
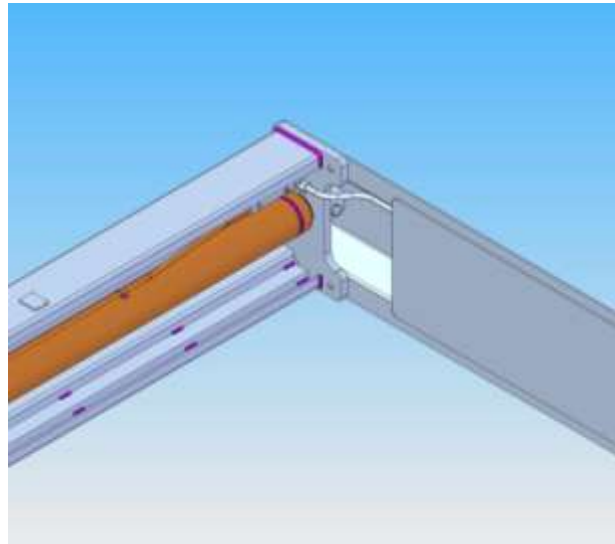

2

Install

STOP microswitches(FC2SX,FC2DX)

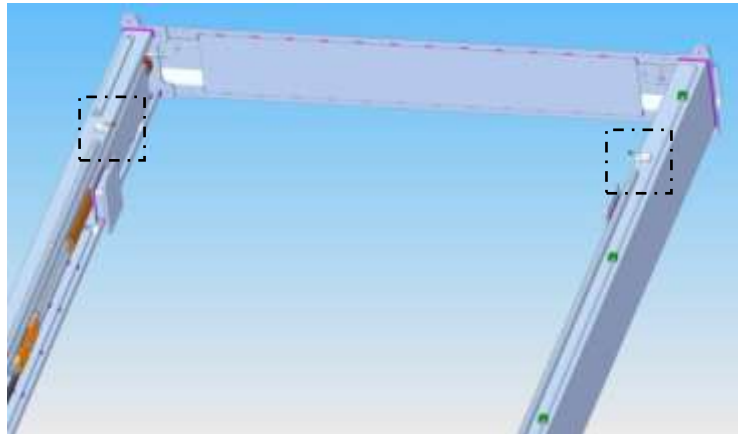

3

A	TYPE	Q.ty	Torque Nm
SCREWS	TCEI M4x16	2x2	2,78

Run the cable through the upper cross brace.

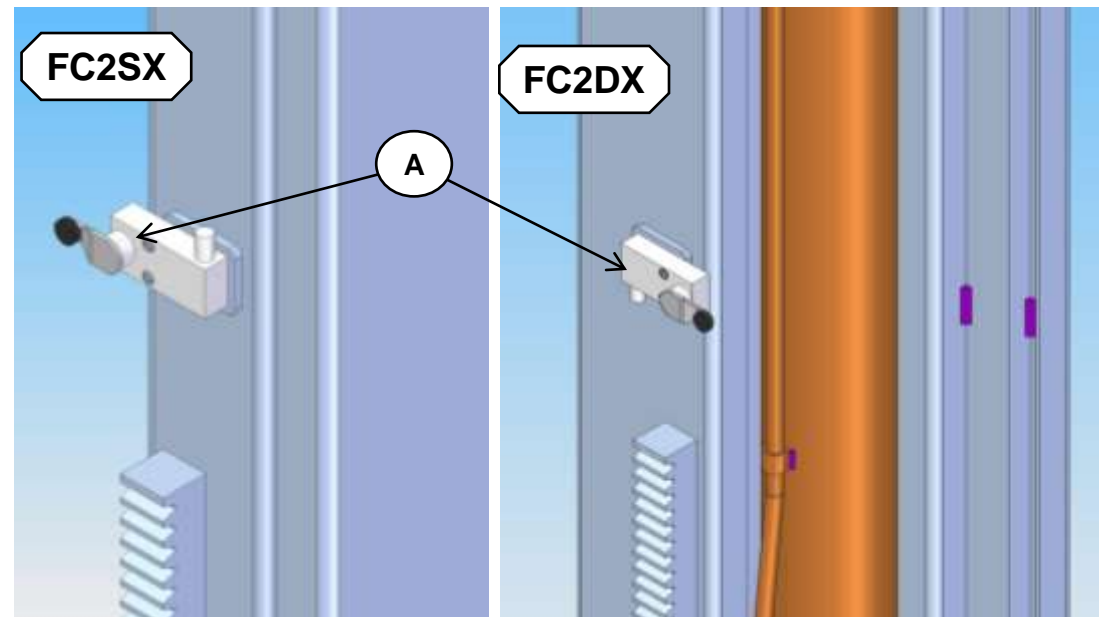

Install a column spacer temporarily (central cross brace)



Place the machine in vertical position.



4

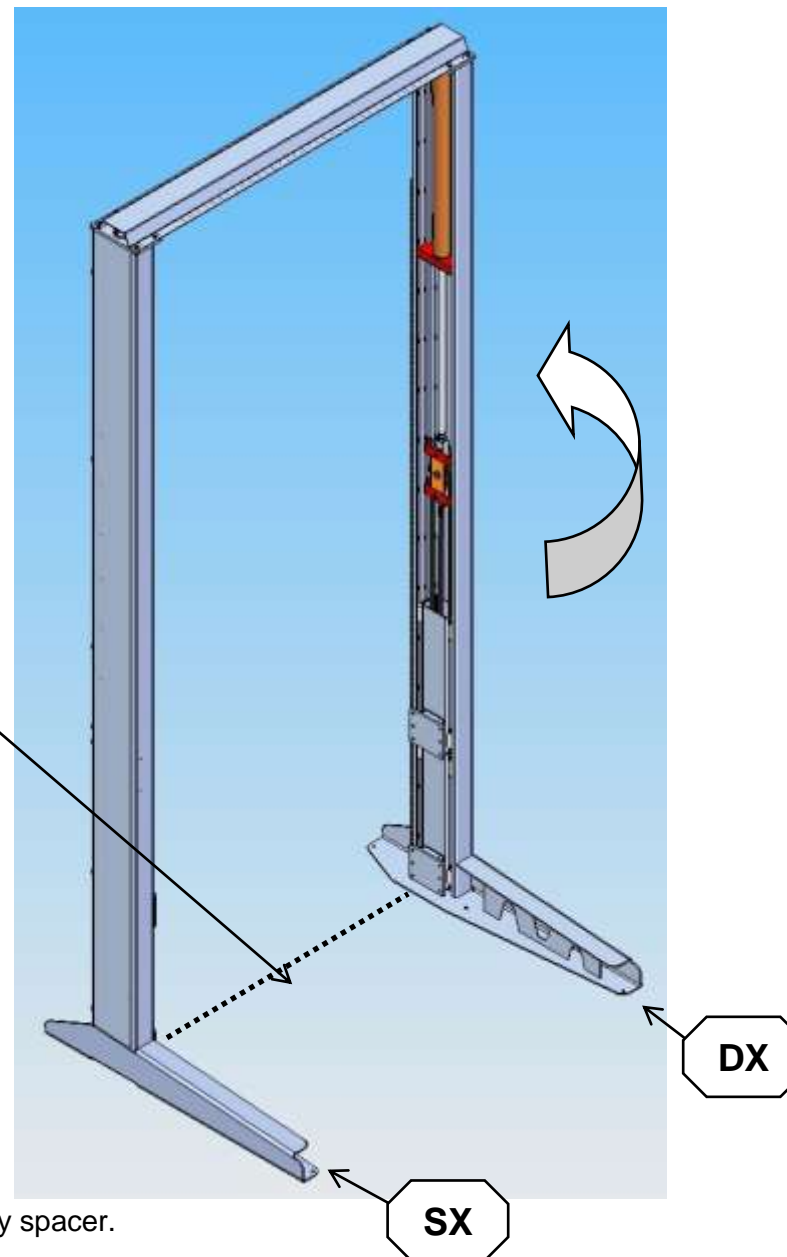

Remove temporary spacer.

5

Fix only 1 anchor of 1st column:

A	TYPE	Q.ty
CHEMICAL ANCHORS	M16X125	1

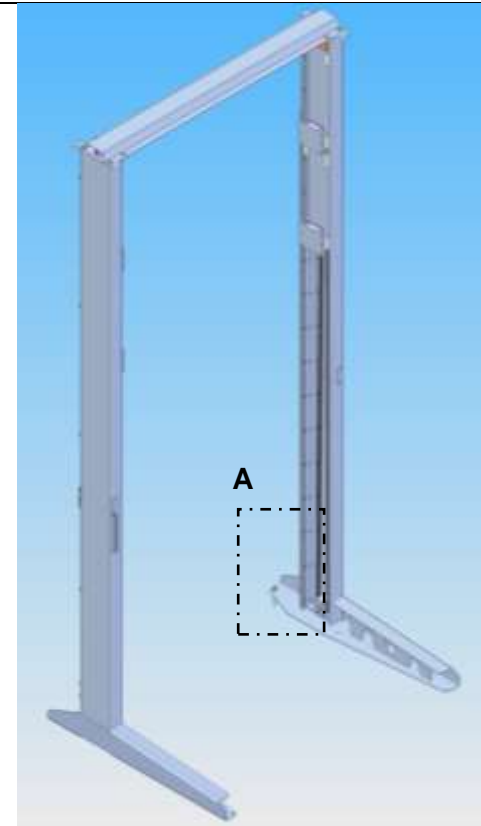
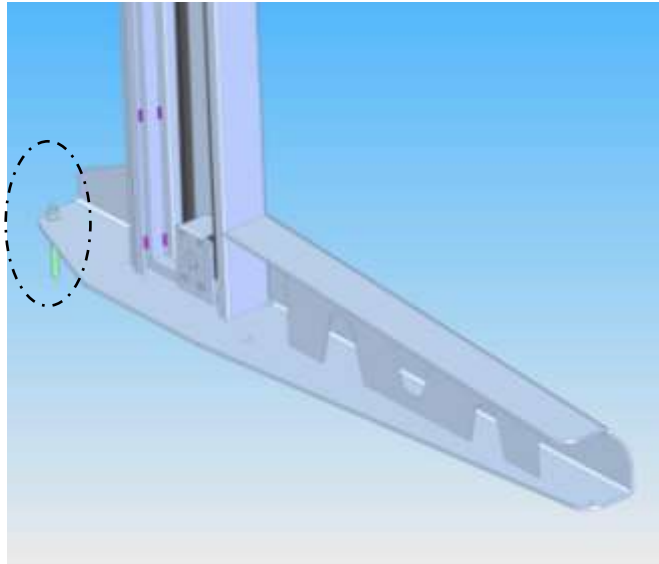

5
a

9.1. *Levelling the lift structure*

If the lift bases are not perfectly level, level these by positioning adequate metal shims under the columns, where necessary.

1. Using a “crowbar”, lift the column at the point where the shims need to be inserted; then slip in the desired shim. The shims must be inserted into the uprights’ connection points at the bases (A).
2. Remove the “crowbar” and once again check whether the base is level by positioning a level crosswise both transversally and diagonally in both directions.

Remove screws and brackets for transportation.

6

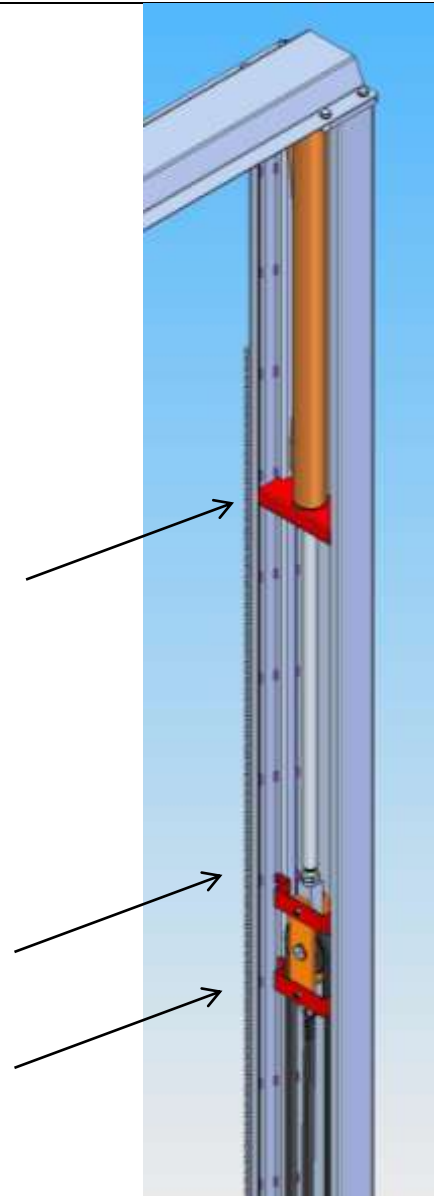
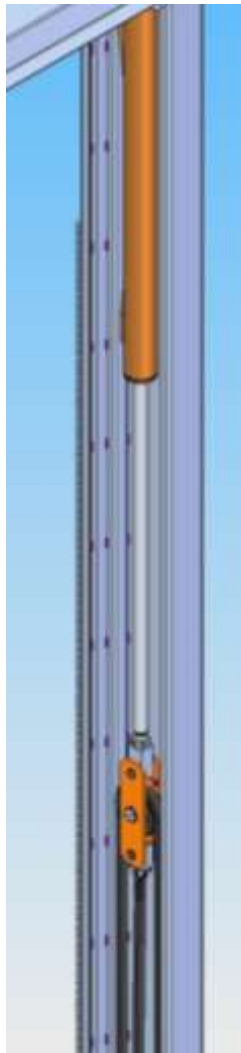

Lower platform guides

Fix:

	TYPE	Q.ty	Torque Nm
SCREW	M16x60	4	198
WASHER	M16	8	/
NUT	M16 Selflocking	4	/

7

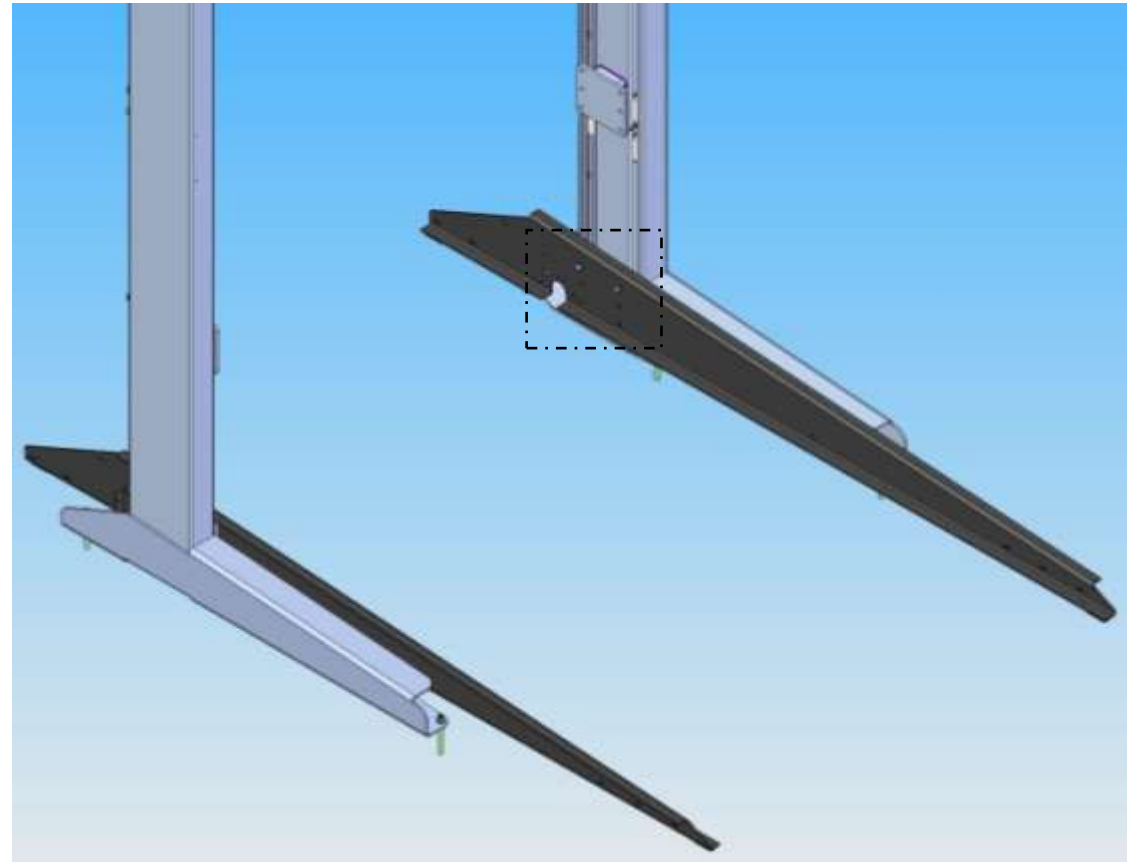
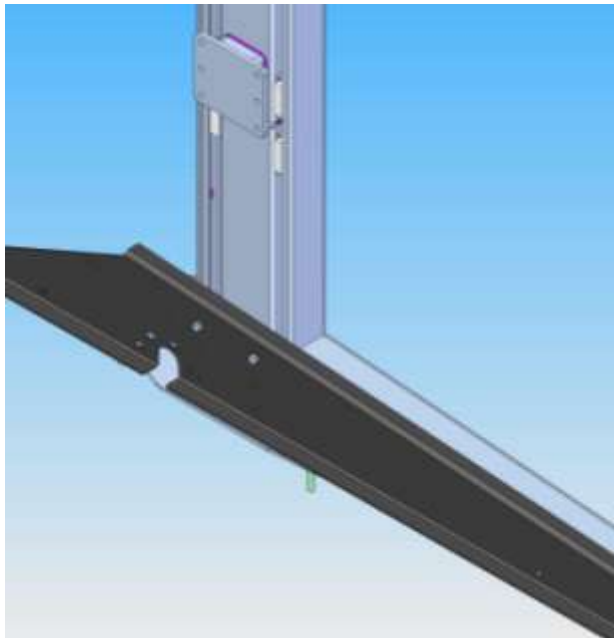

Central lower cross brace

Insert and fix:

	TYPE		Q.ty	Torque Nm
SCREW	TE M16x70		8	198
WASHER	M16		16	/
NUT	M16	Selflocking	8	/

8

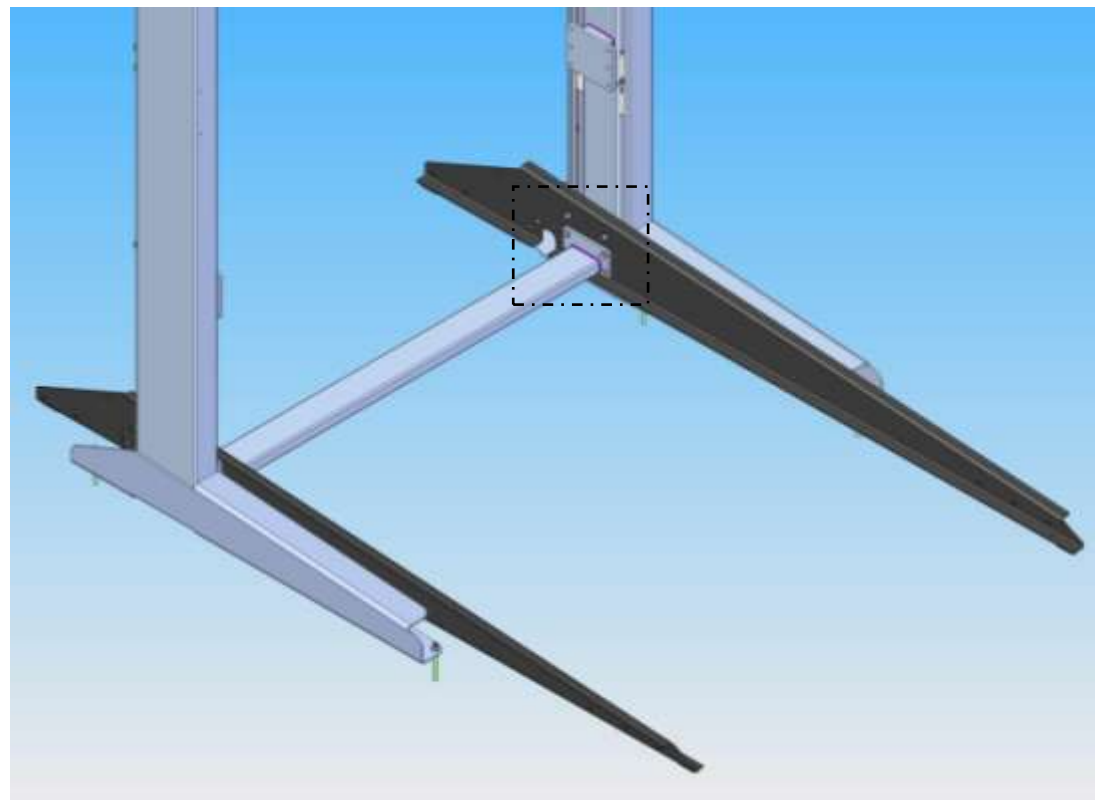
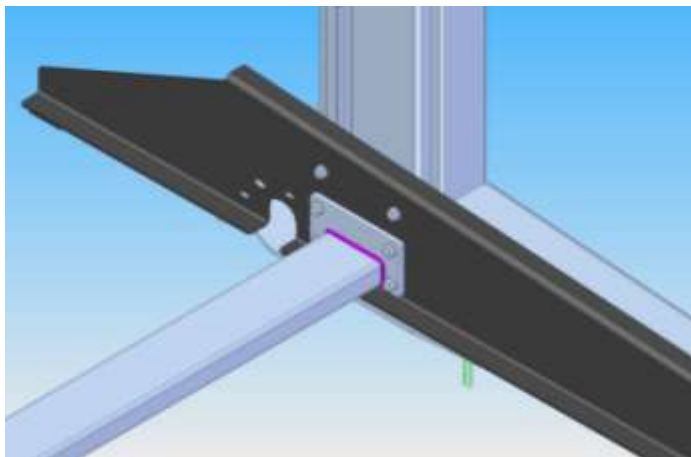

Torsion bar

- Insert torsion bar
- Insert right and left safety locks

	TYPE		Q.ty	Torque Nm
SCREW	M16x70		4	198
NUT	M16	Selflocking	4	/

9

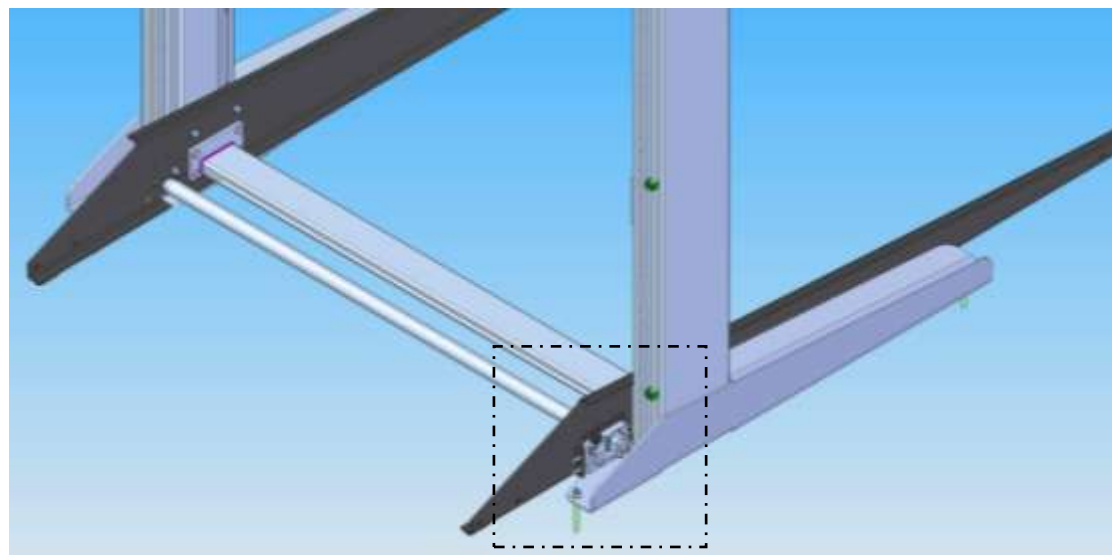
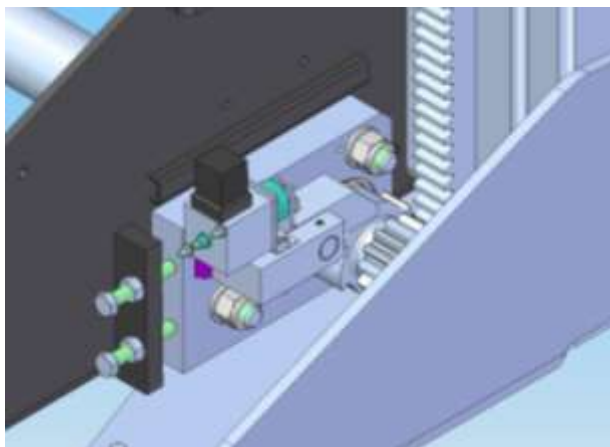

Lower platform (nr.1)

Install following the order below:

- 1 central cover
- 2 slats (7+1)
- 3 rear head

	TYPE	Q.ty	Torque Nm
SCREW	TE M8x35	4	23
WASHER	M8	8	/
NUT	M8 Selflocking	4	/

- 4 front tip

	TYPE	Q.ty	Torque Nm
SCREW	TE M8x35	6	23
WASHER	M8	12	/
NUT	M8 Selflocking	6	/

- 5 the cables protection

- Compact the slats before fixing them
- Drill the central cover
- Fix

	TYPE	Q.ty	Ø Hole
SCREW	ST 4,8x16	3	4,25 mm

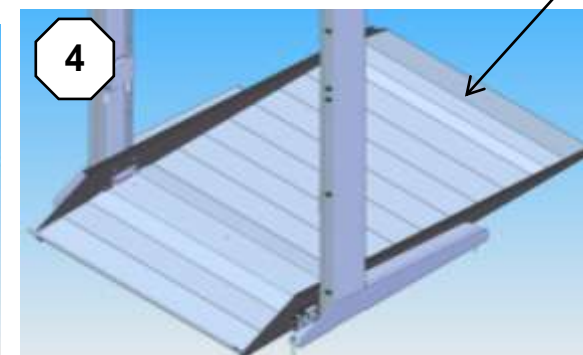
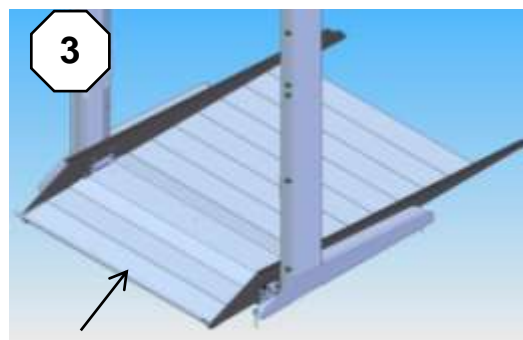
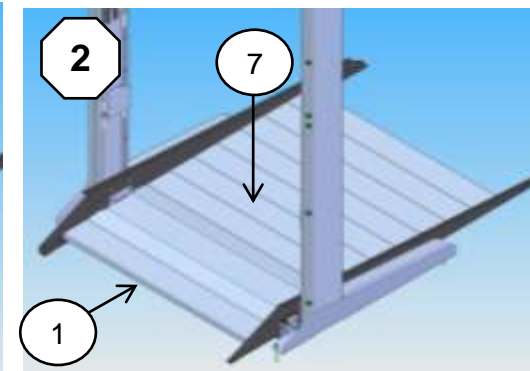
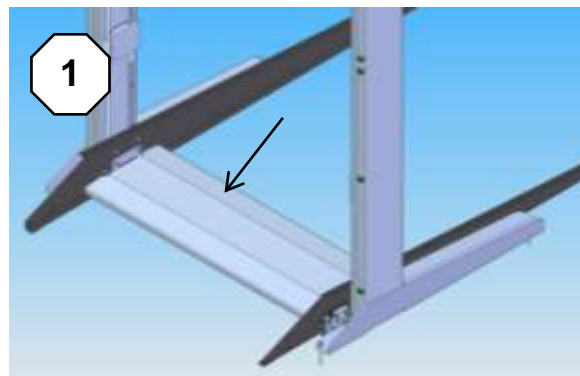

10

11

Upper platform guides
 Insert right and left guides:

	TYPE		Q.ty	Torque Nm
SCREW	M16x70		12	198
WASHER	M16		24	/
NUT	M16	Selflocking	12	/

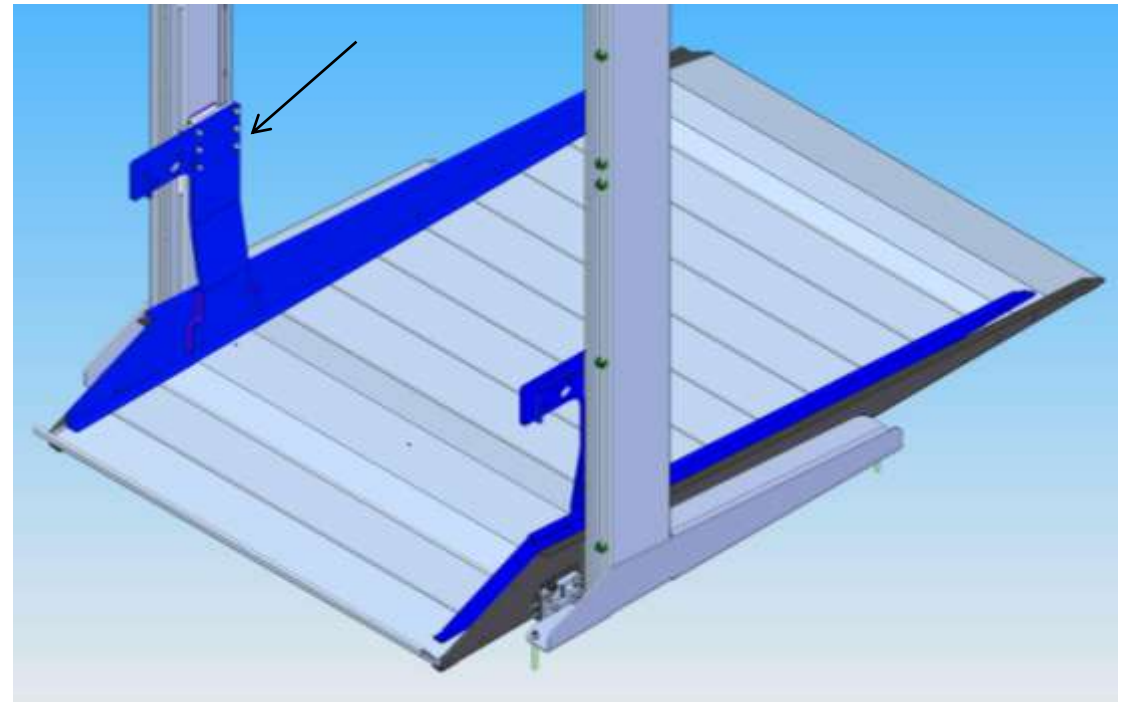

12

Upper central cross brace

	TYPE		Q.ty	Torque Nm
SCREW	TE M16x70		8	198
WASHER	M16		16	/
NUT	M16	Selflocking	16	/

Move up and down the platform.

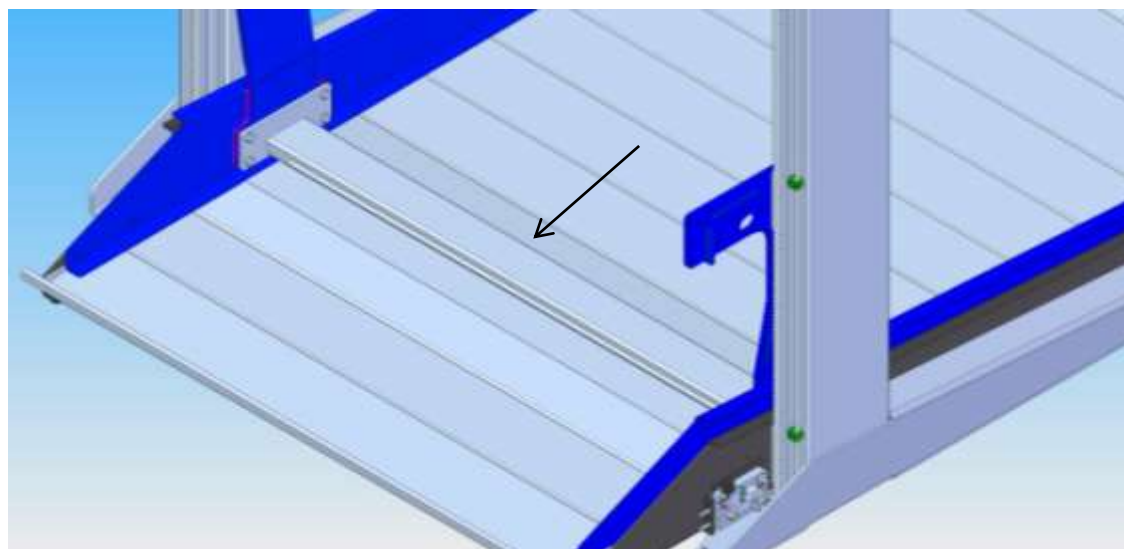

13

Upper platform (nr.2)

Install following the order below:

- 1 cover (C)
- 2 6 slats (D) +2 with bar (DB)
- 3

a. Rear head (T)

	TYPE	Q.ty	Torque Nm
SCREW	M8x35	4	23
WASHER	M8	8	/
NUT	M8 Selflocking	4	/

b. Front tip (P)

	TYPE	Q.ty	Torque Nm
SCREW	M8x35	6	23
WASHER	M8	12	/
NUT	M8 Selflocking	6	/

- Compact the slats before fixing them
- Drill the central cover
- Fix

	TYPE	Q.ty	Ø Hole
SCREW	ST 4,8x16	3	4,25 mm

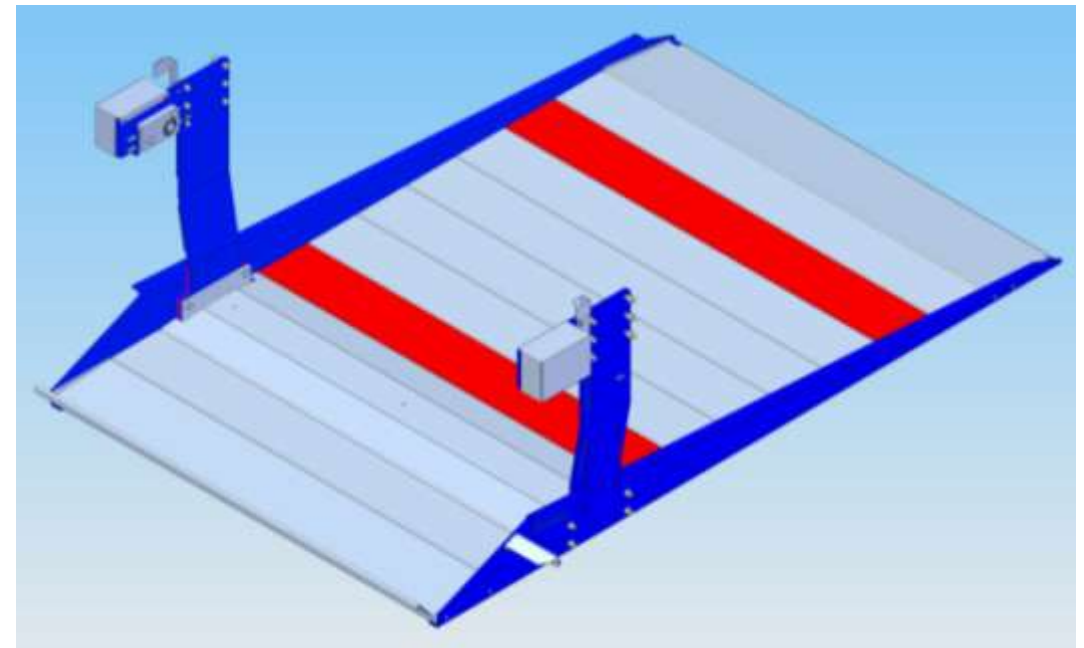
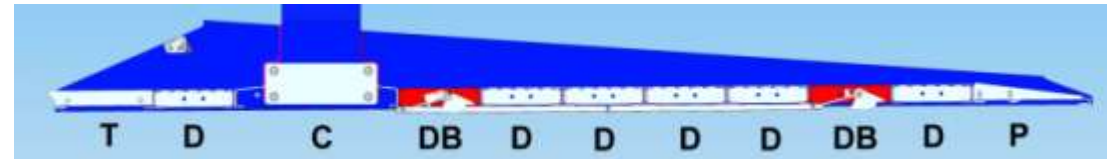
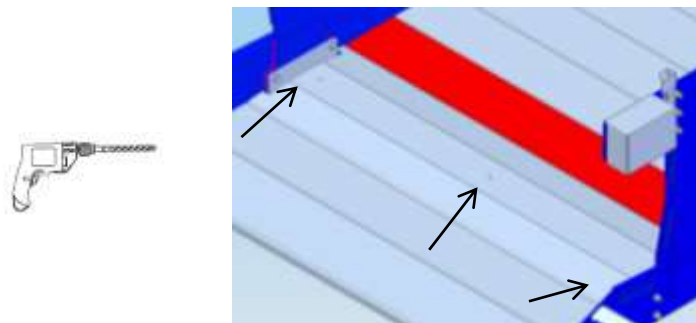

Installation of upper torsion bar

1. Right:

	TYPE		Q.ty
SCREW	M16x70		4
NUT	M16	Selflocking	4

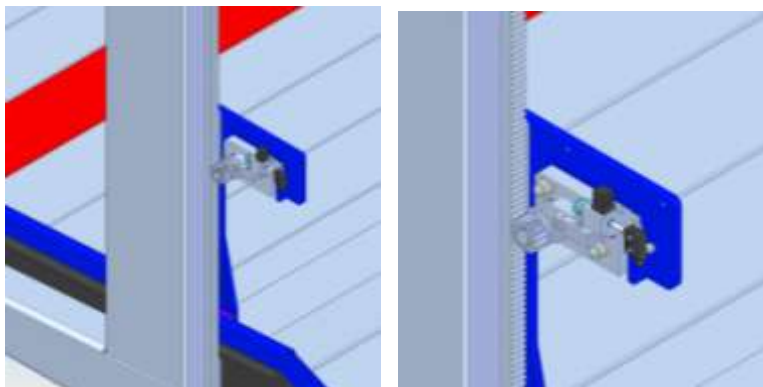

2. Left:

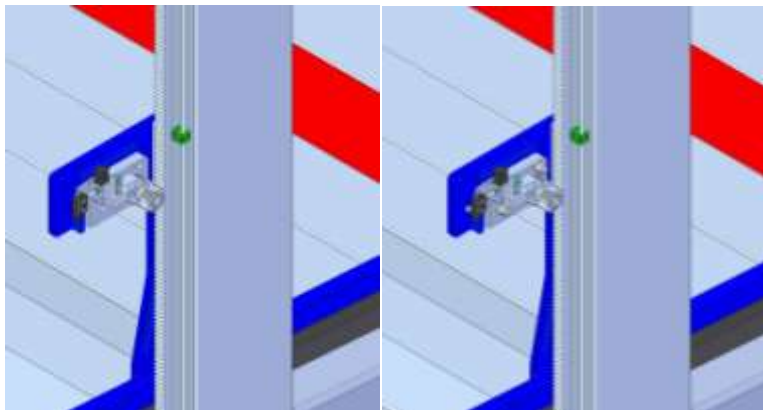

ATTENTION: Alignment of the mechanical locks teeth

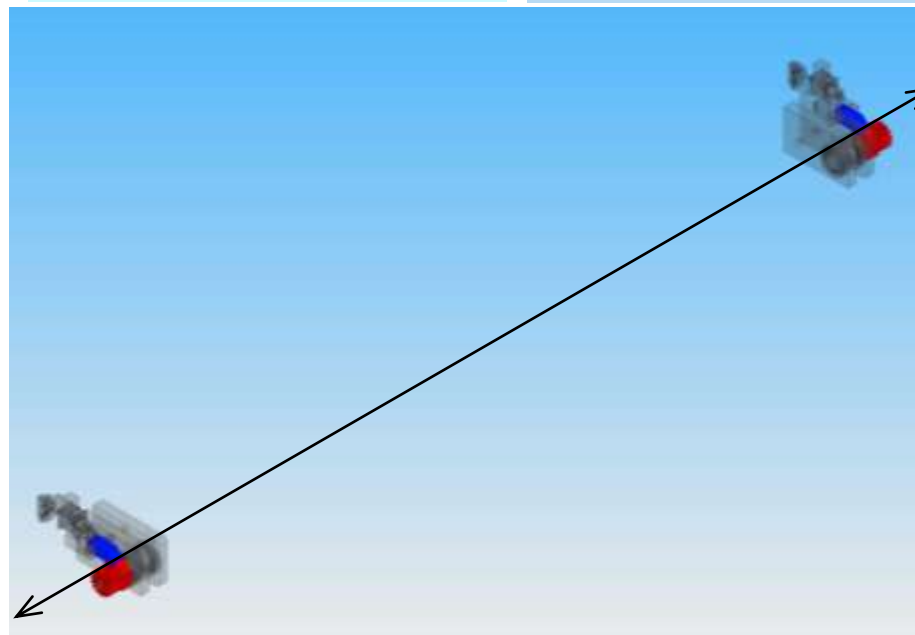
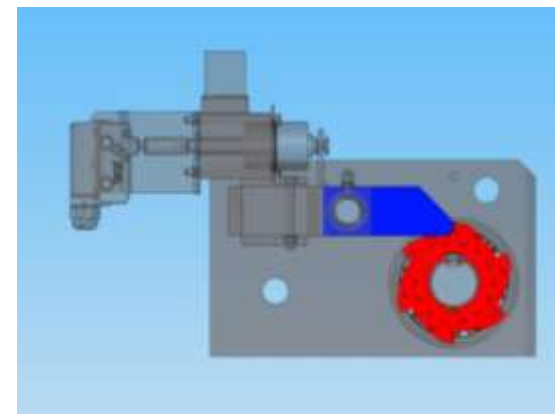
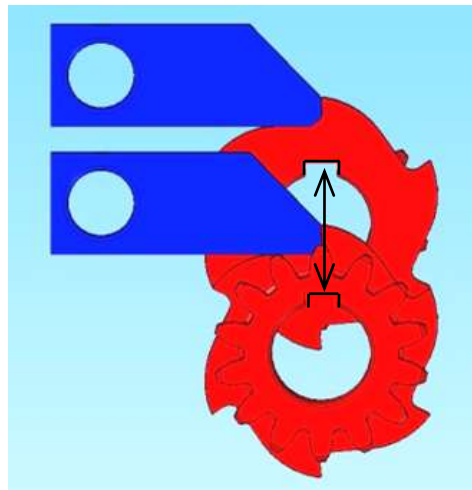

Install:

Magnet check microswitch (FCSX e FCDX)

and

Magnets (M2)

		TYPE	Q.ty	Torque Nm
5	WASHER	M4	6	/
6	SCREW	M4X25	2	2,78
7	NUT	M4	4	/
8	SCREW	M4X40	2	2,78
11	SCREW	M4X55	2	2,78

15

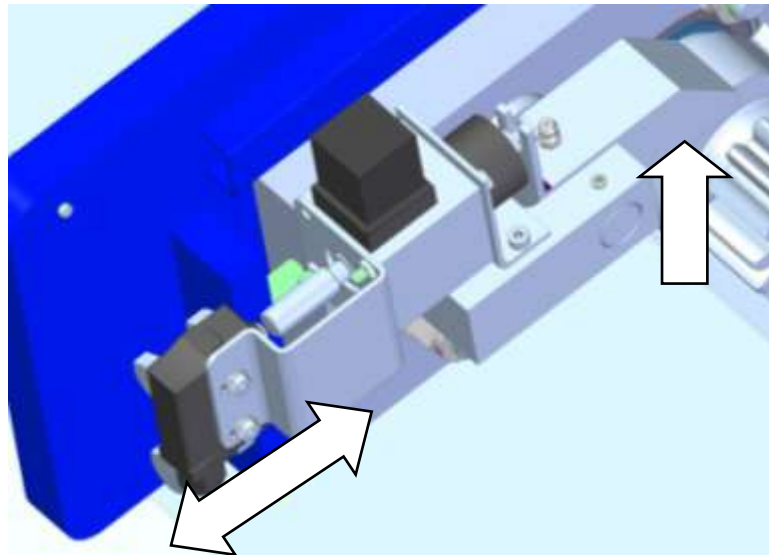

ATTENTION: Adjust the position of the FCSX and FCDX switches to allow complete opening of the mechanical jack.

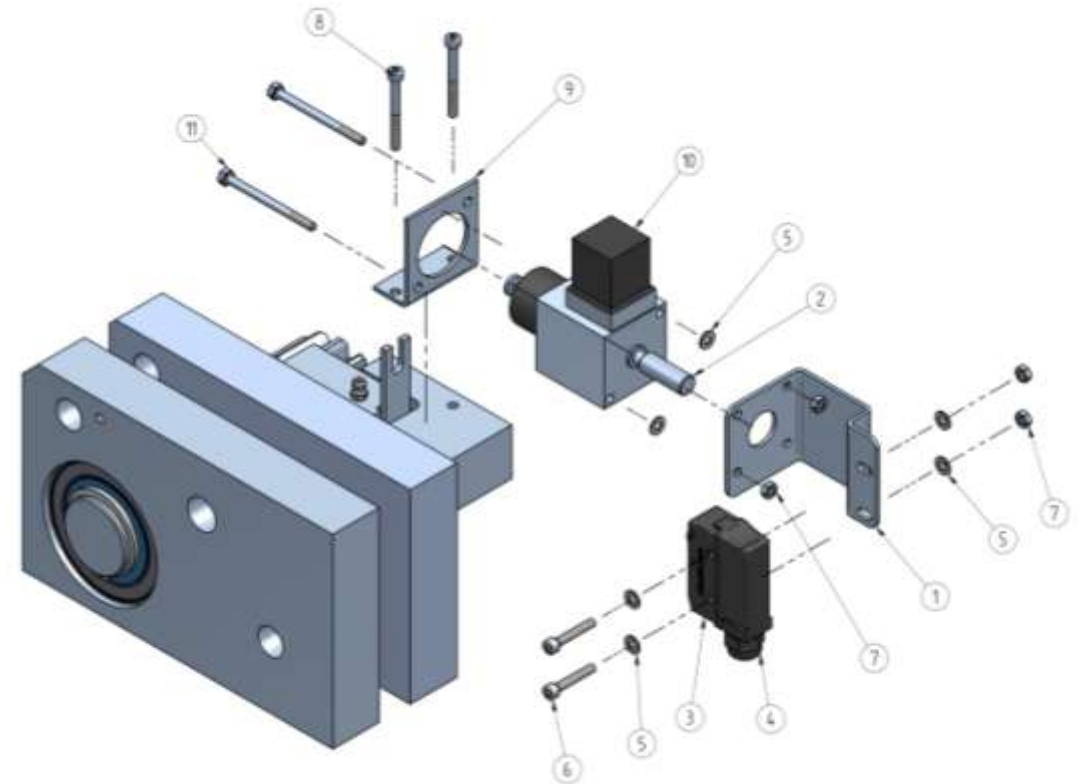

16

Install brackets

B	TYPE	Q.ty	Torque Nm
SCREW	M6x40	2x2	2,78
WASHER	M6	4x2	/
NUT	M6 Selflocking	2x2	/

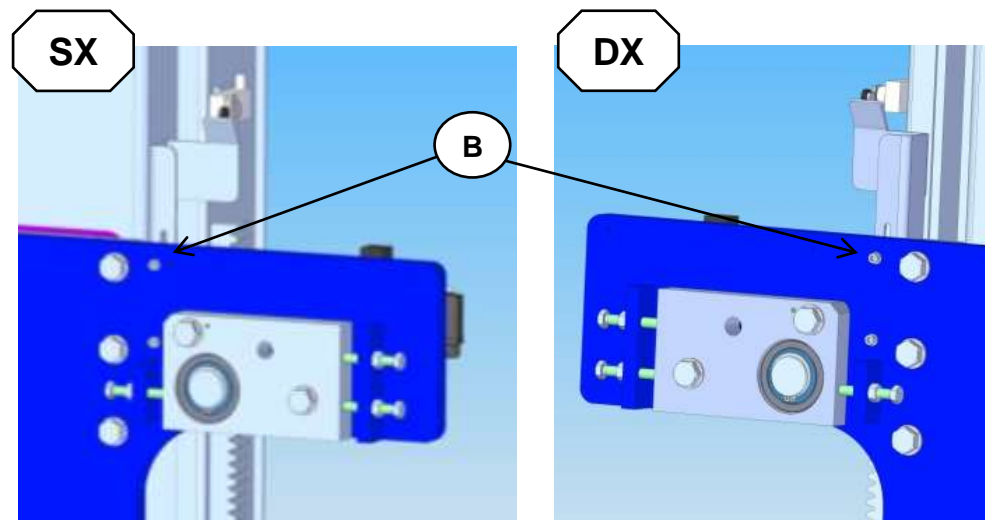

Install bracket for:

STOP microswitch (FCI1)

A	TYPE	Q.ty	Torque Nm
SCREW	TCEI M4x16	2	2,78
B	TYPE	Q.ty	Torque Nm
SCREW	TCEI M5x16	2	5,5

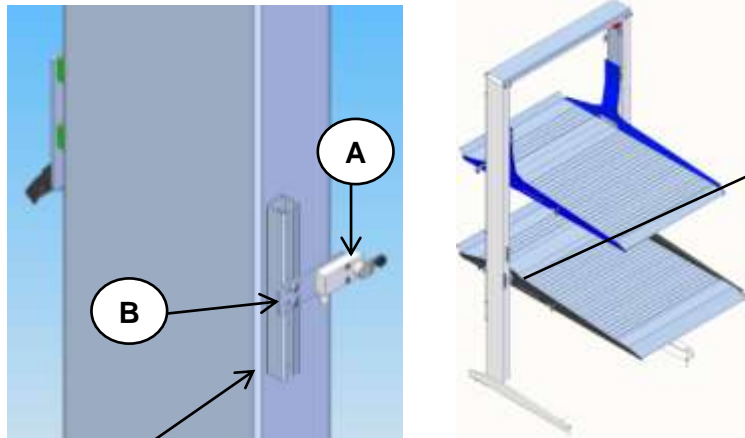

17

Fix the position of the limit switch by adjusting the desired height of the lower platform according to the following diagram:

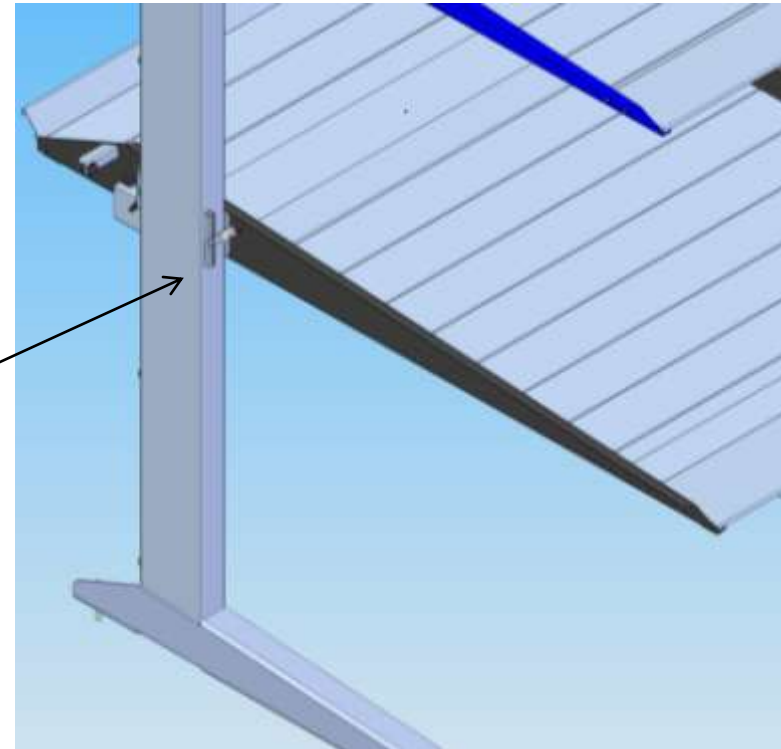
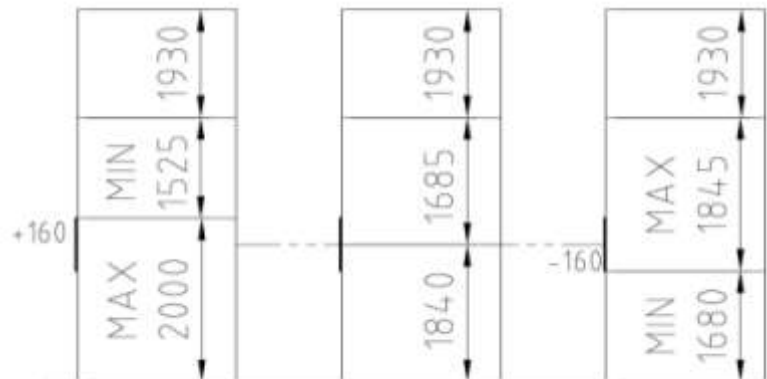

Adjust the bracket **B** so that the bracket **D** have 1 mm GAP between the teeth tip of the pinion and the bottom of the rack

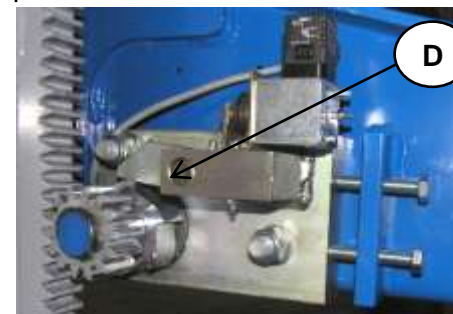

IMPORTANT
AFTER ADJUSTING THE LIMIT SWITCH, FILL THE HEIGHTS ON THE "OPERATION INSTRUCTION" TABLE

2		h max 1930 mm
1		h max <input type="text"/> mm
T		h max <input type="text"/> mm

BYPASS microswitch (FCBY2)

D	TYPE	Q.ty	Torque Nm
SCREW	TCEI M5x50	2	5,5
NUT	M5 Selflocking	2	/

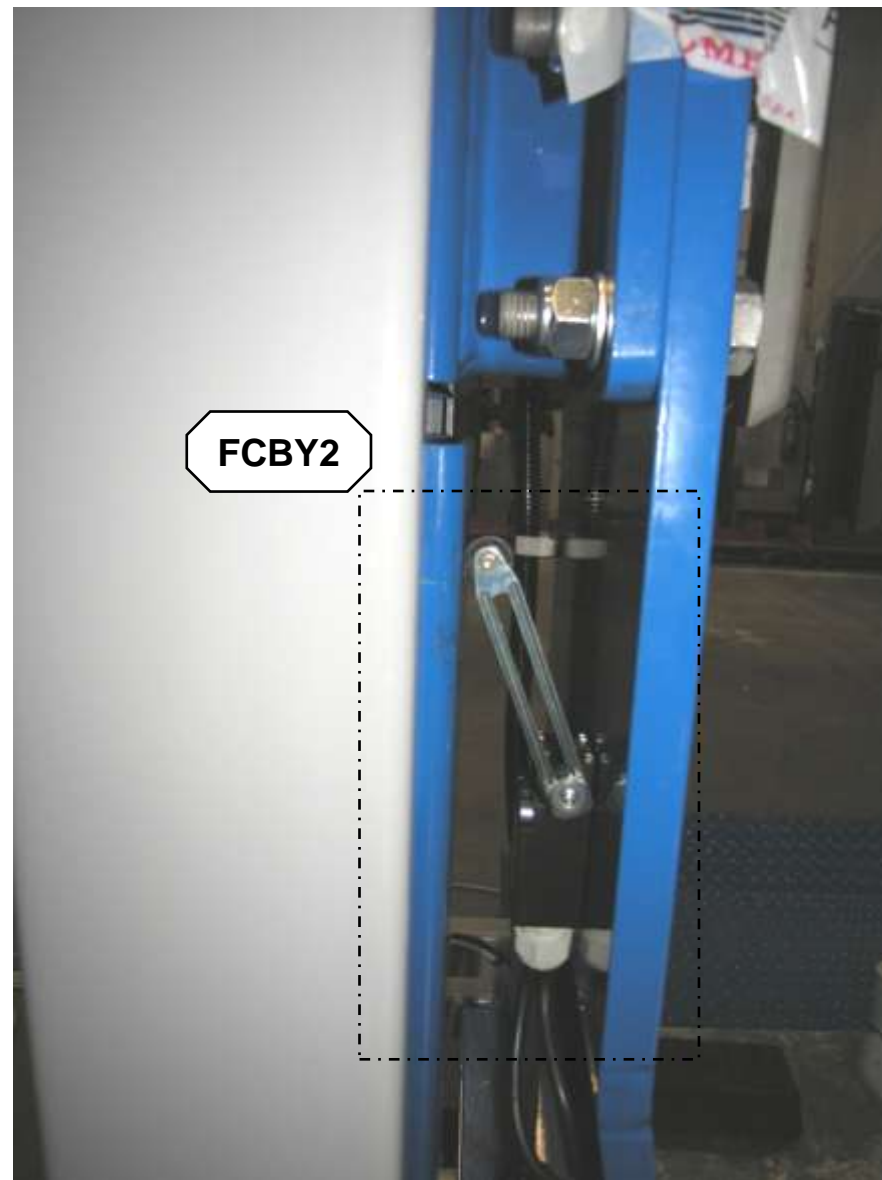
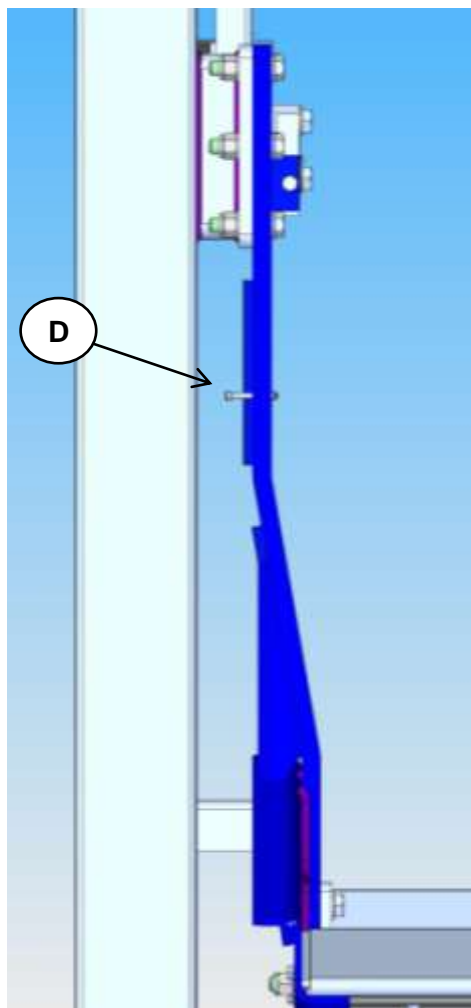

18

Photocell (FOT) and reflector (CAT) (*OPTIONAL*)
on platform:

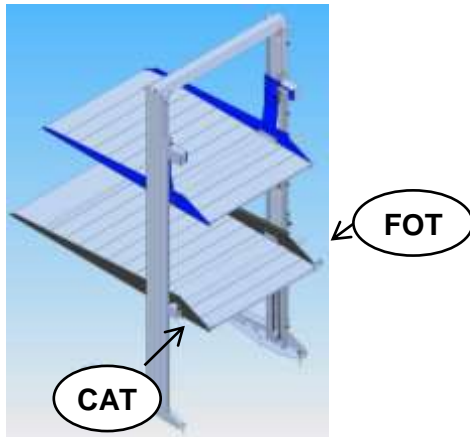

19

FOT

		TYPE	Q.ty	Torque Nm
2	PHOTOCELL		1	/
4	SCREW	TBEI M8X30	2	23
5	NUT	M8	2	/
6	WASHER	M8	4	/
7	NUT	M4	2	/
8	NUT	M5	2	/
9	SCREW	TE M5X12	2	5,5
10	SCREW	TCEI M4X20	2	2,78

CAT

		TYPE	Q.ty	Torque Nm
4	SCREW	TBEI M8X30	2	23
5	NUT	M8	2	/
6	WASHER	M8	4	/

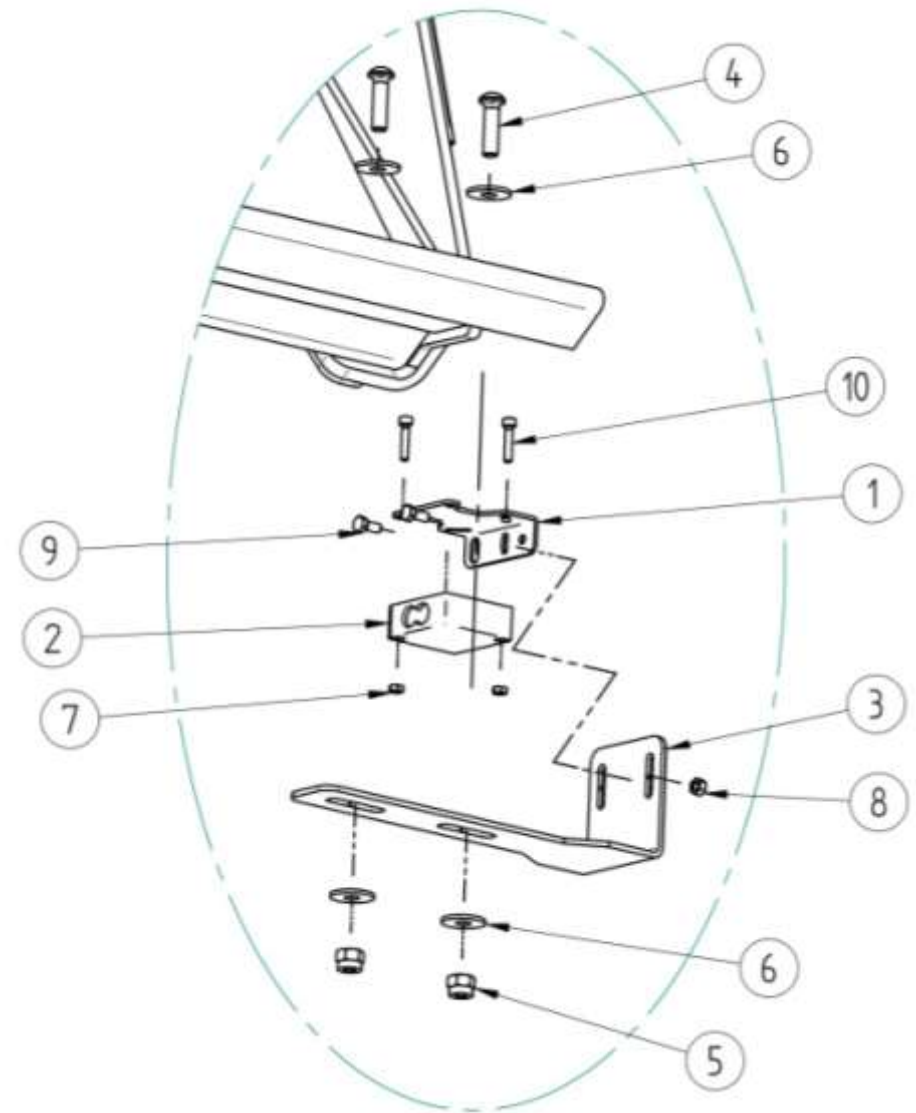

20

Installation of lower platform's plastic chain bracket:

	TYPE	Q.ty	Torque Nm
SCREW	TSPEI M4x20	2x2	2,78
WASHER	M4	4x2	
NUT	M4	2x2	

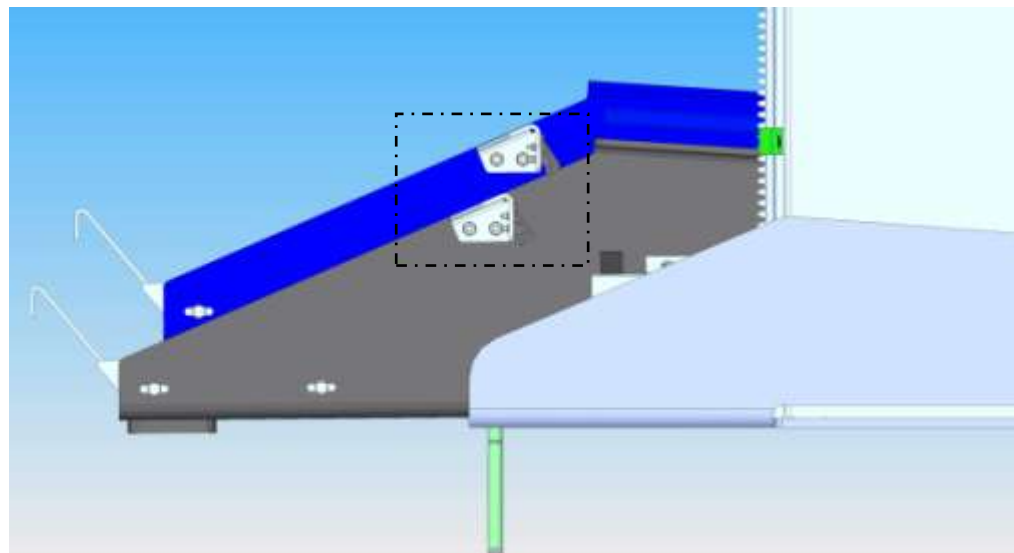
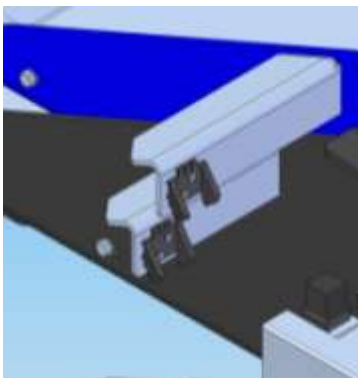

21

Install the plastic chain:

A	TYPE	Q.ty	Torque Nm
SCREW	TSPEI M4x10	2	2,78

B	TYPE	Q.ty	Torque Nm
SCREW	TSPEI M4x20	2	2,78

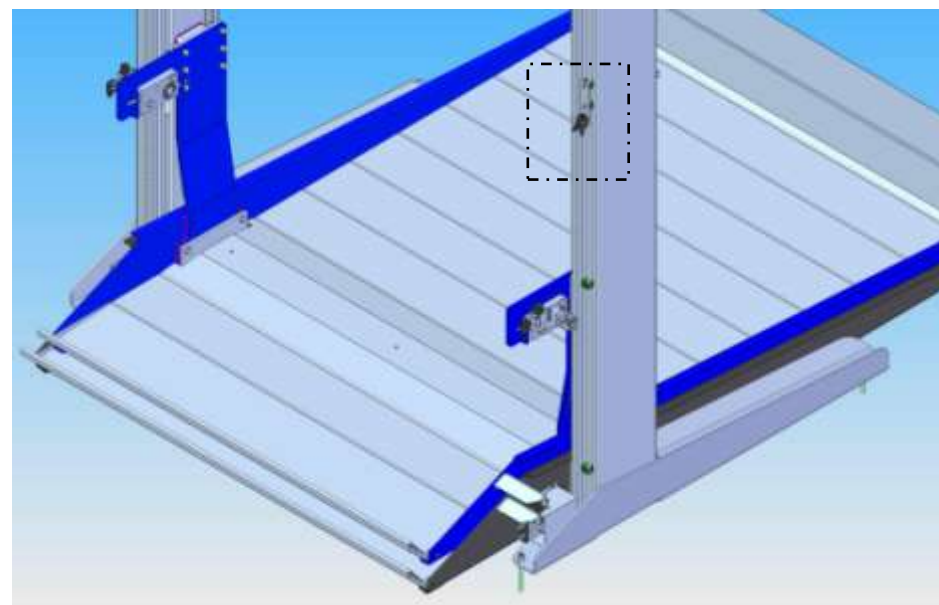
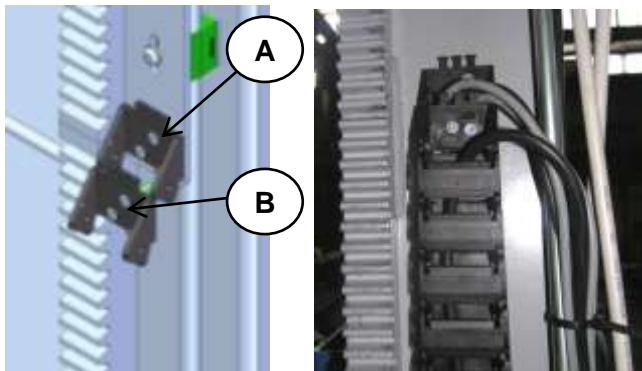

9.2. *Wiring connections*

Warnings for the installation of electric cables between the control unit and lift

Wire as follows:

- a) Connect to relevant numbers on the terminal board (A) inside the electrics box
 - Cables from lift (microswitch)
- b) Connect the power cable to the electrics system.

22

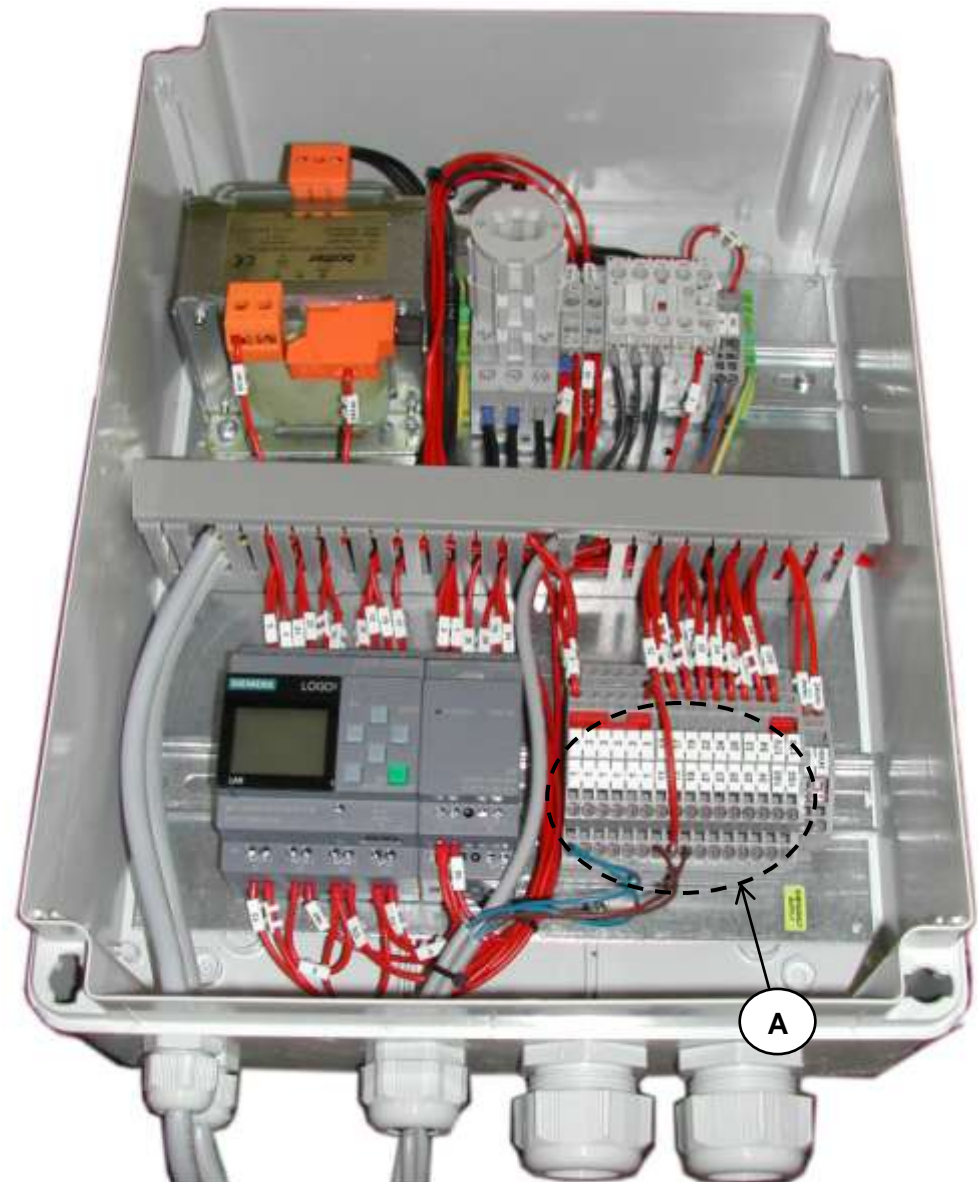

CABLE CONNECTION

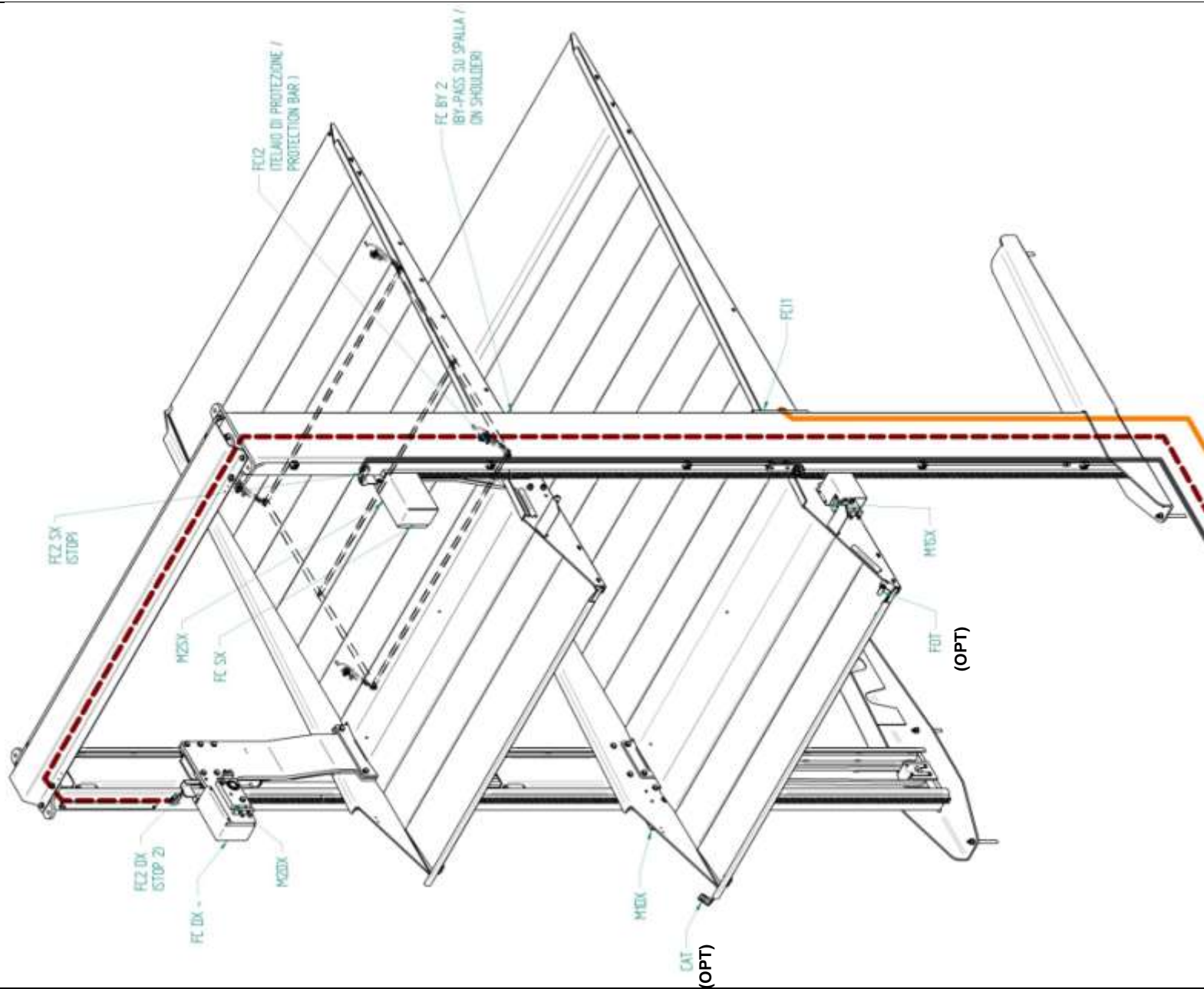

<p style="text-align: center; font-size: 24pt; font-weight: bold;">23</p>	<p>9.3. Hydraulic connections</p> <p>Connect hoses with corresponding connectors to the hydraulic unit.</p> <p>(See: <i>Connection of hydraulic unions</i>)</p>	
<p style="text-align: center; font-size: 24pt; font-weight: bold;">24</p>	<p>Over the system and refill the oil tank.</p>	

Tipo di olio/Marca Oil Type/Brand Name	Viscosità Viscosity mm ² /s	Temp. C°	Q.tà Q.ty lt	Grasso Lubricating Grease
HYDROIL GF 46	44	40	18	GREASE LC2

9.3.1. Connection of hydraulic unions

The union locking procedure is as follows:

:

A	On THE BENCH
A1	Fit the nut manually on the ogive using the manual pre-assembly tool provided.
A2	Turn the wrench through 1.5 turns to compress the ogive and fasten it to the hydraulic tube.
A3	Remove the nut. Check that the ogive can turn but does not slide.

B	ON SITE OF INSTALLATION
B1	Manually fit the nut.
B2	Close with wrench as follows: <ul style="list-style-type: none"> - 0.5 TURNS for DIAMETER < 16 MM - 0.75 TURNS for DIAMETER >= 16 MM

C	After these operations the union is closed correctly. Tightening the nut more than indicated causes excessive deformation of the ogive and can compromise the hold of the hydraulic union.
---	---

N.B :

The hydraulic pipe must have the following characteristics:

- It must be cut perpendicular to the axis
- It must be burr-free.

25

Check the oil level.

9.4. Levelling the complete stacker

If the lift bases are not perfectly level, level these by positioning adequate metal shims under the columns, where necessary.



Lift levelling operations has to be rechecked after the machine's wiring and hydraulic connections have been made.

26

Perform the following operations in the order indicated:

3. Access the lift and proceed with the upstroke phase in order to facilitate the levelling process.
4. Stop the lift when it reaches a suitable height to be able to work comfortably, by locking the mushroom head emergency button and the main switch in the closed position.
5. Using a "crowbar", lift the column at the point where the shims need to be inserted; then slip in the desired shim. The shims must be inserted into the uprights' connection points at the bases (**A**).
6. Remove the "crowbar" and once again check whether the base is level by positioning a level crosswise both transversally and diagonally in both directions.

27

Ground anchoring

- Make 2 complete strokes of the lift
- Check the correct functioning of gears and torsion bar
- Bring both platforms again to the ground
- Check the perpendicularity between platforms and bases
- Fix to the ground with all anchors

	TYPE	Q.ty
CHEMICAL ANCHORS	M16X125	5

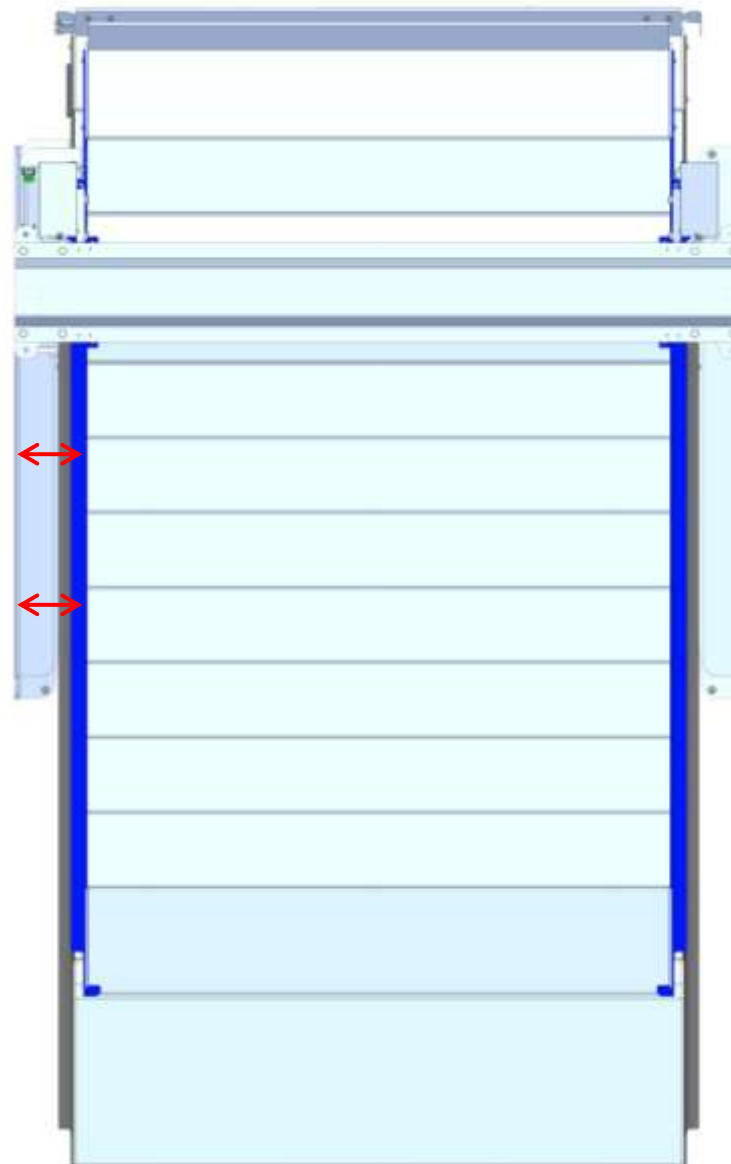

9.5. Installing chemical anchors

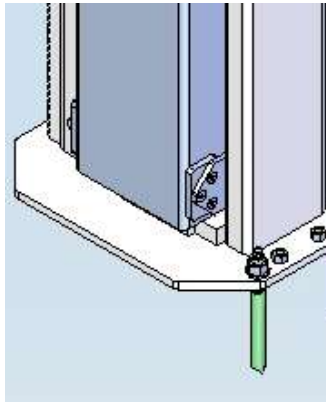

Lift levelling operations may only be performed after the machine's wiring and hydraulic connections have been made.

After having correctly positioned the lift and after having checked that the support bases are level, lock the lift to the floor of the shaft performing the following operations in the order indicated:

1. Drill holes in the floor of the shaft using the holes in the base of the lift as point of reference.
2. Fix the bars to the floor using chemical screw anchors, follow the instructions provided by the screw anchor manufacturer for their installation.

The installation sequence is as follows:

1. Drill a hole
2. Blow out all dust and fragments with compressed air
3. Insert the vial
4. Insert the anchoring substance
5. Wait until gelling has set in (t_{rel})
6. Wait for the compound to harden (t_{cure})
7. Tighten to set torque (T_{inst})

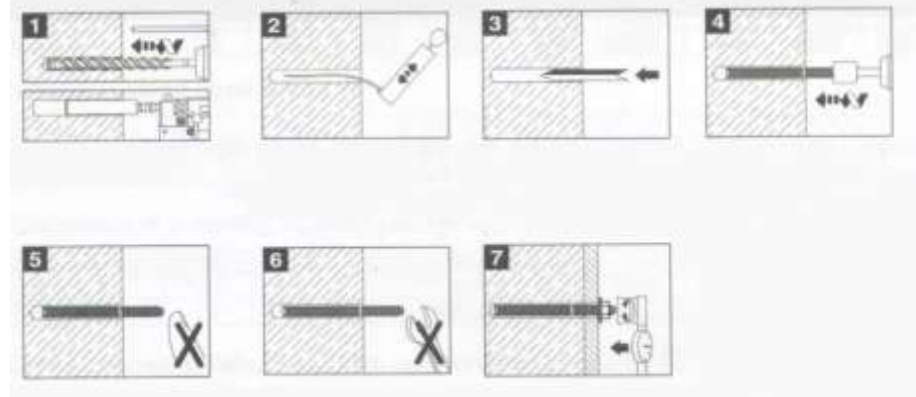

°C	t_{rel}	t_{cure}
-5°... 0°	60'	5 h
0°... 10°	30'	60'
10°... 20°	20'	30'
20°... 40°	8'	20'

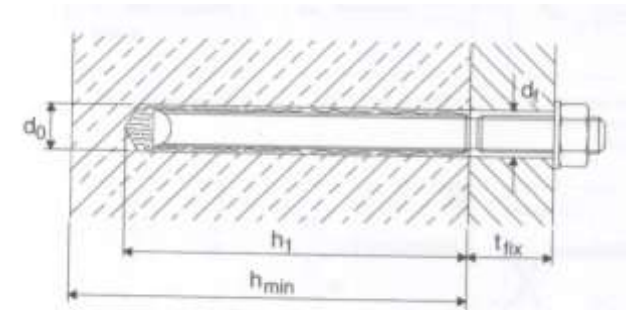

ANCHOR DIMENSIONS		M16		
PLASTIC LAMINATE VIAL	M16X125			
THREADED BAR	M16X190			
DIAMETER OF DRILL BIT	d_0	mm	18	
HOLE DEPTH	$h_1 (=h_{nom})$	mm	125	
MIN. THICKNESS OF BASE MATERIAL	$h(min)$	mm	170	
MAX. THICKNESS TO BE SECURED	$t_{fix}(max)$	mm	38	
DIAMETER OF HOLE IN PLATE	d_f	mm	cons.	18
			max.	19
TORQUE	T_{inst}	Nm	100	
PINS NUMBER	n°	6		

Covers

Insert the protection covers on the lower platform:

	TYPE	Q.ty	Torque Nm
SCREW	TCEI M5x20	2x2	5,5
WASHER	M5	4x2	
NUT	M5	2x2	

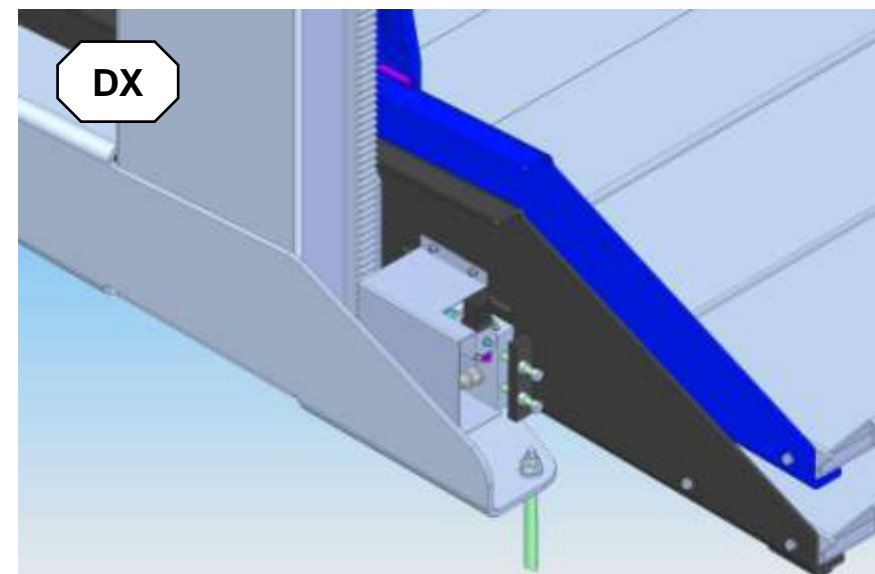
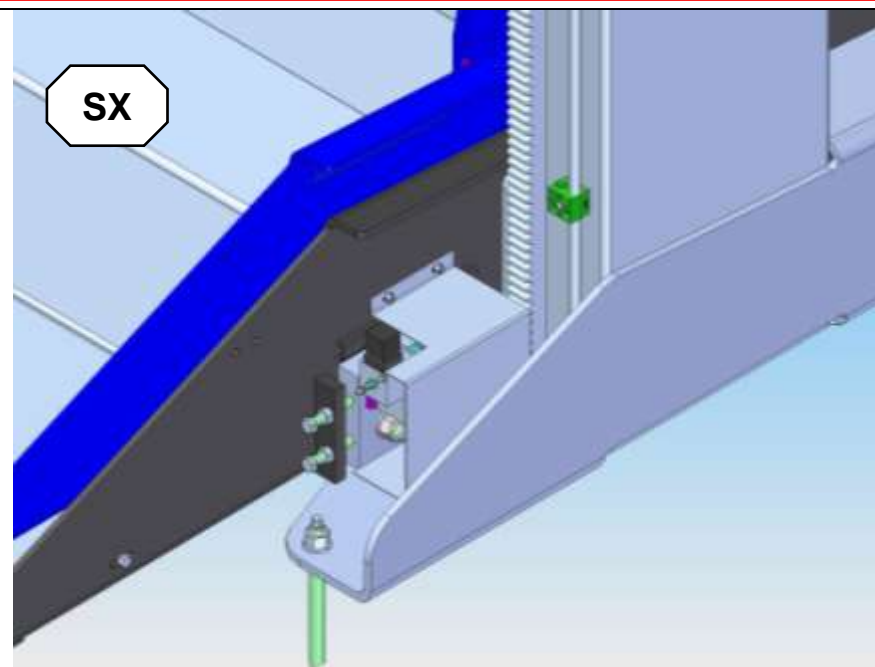

28

29

Insert the protection covers on the upper platform:

	TYPE	Q.ty	Torque Nm
SCREW	TCEI M5x25	2x2	5,5
WASHER	M5	4x2	

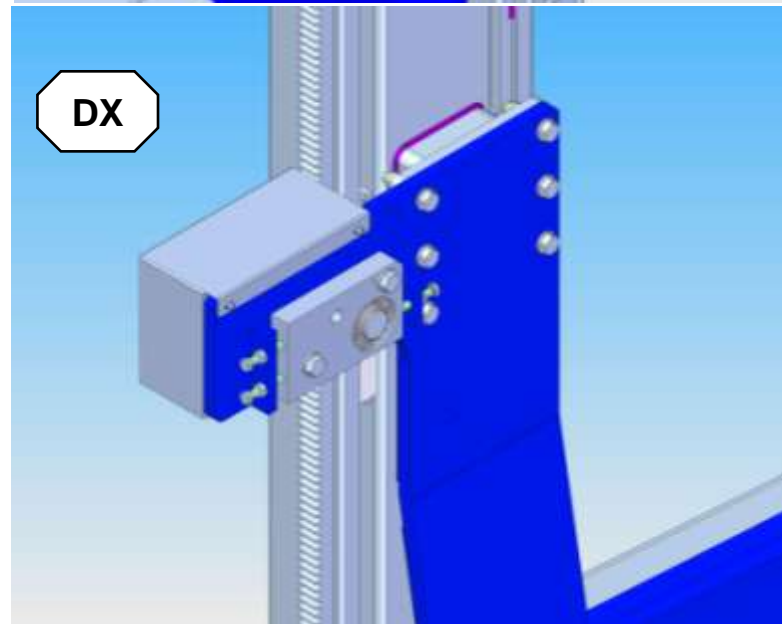
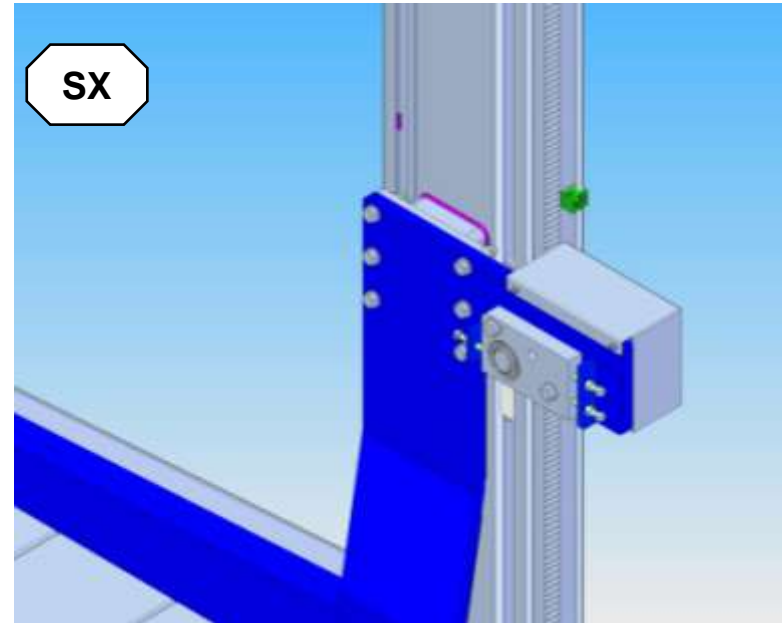

Install safety bar

Fix the levers to the slats:

		TIPO	Q.tà	Coppia di serraggio Nm
7	SCREW	M10x45	4	46
10	NUT	M10	4	/
12	NUT	M10 Selflocking	4	/
13	WASHER	M10	4	/
14	WASHER	M10		8/

30

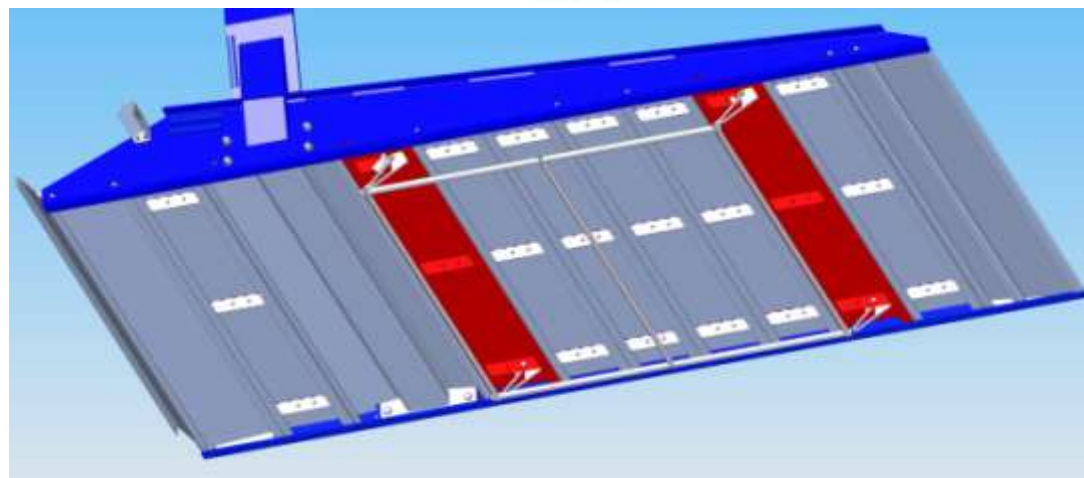
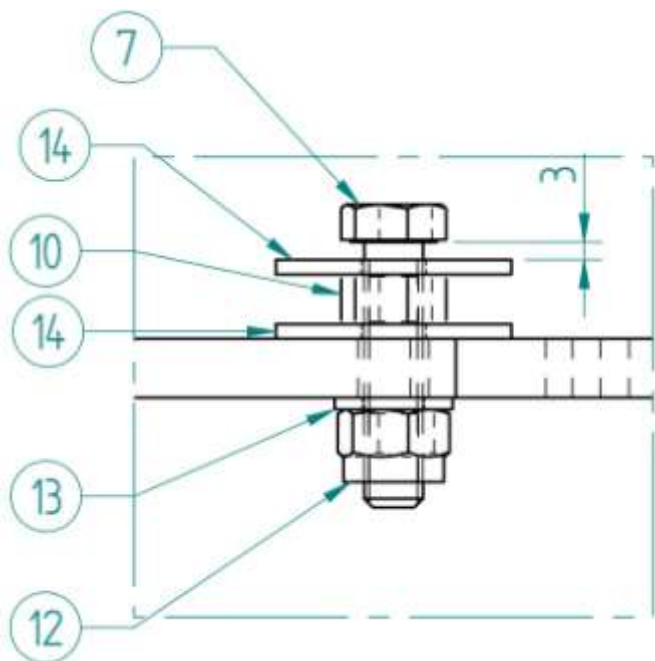

BE CAREFUL TO THE ASSEMBLY DIRECTION

Fix the frame to the levers with the self-drilling screws (ST 4.8x16, q.ty 4 pieces):

OPEN FRAME

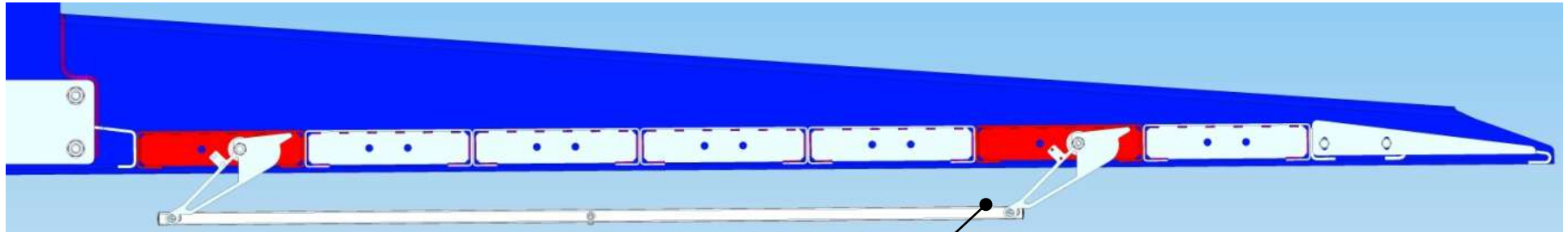

CLOSED FRAME

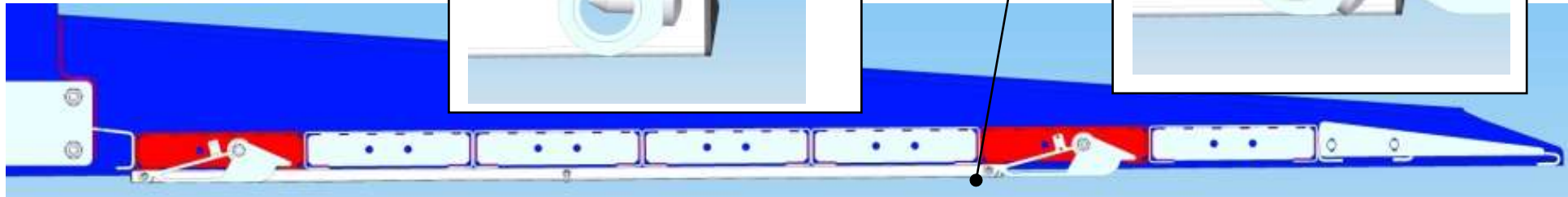

31



ATTENTION:

- Check that bar moves freely
- Check that the limit switch, if pressed, sends the stop signal and that this does not exceed 30 mm of movement, otherwise adjust the limit switch lever.

POSITION OF FCI2 WITH OPEN FRAME

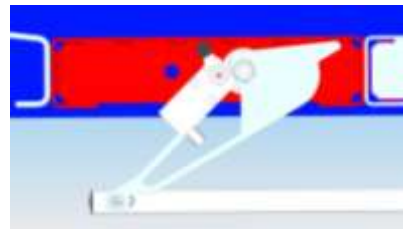

POSITION OF FCI2 WITH CLOSED FRAME



32 Lubricate the columns along the entire sliding of pads.

OPTIONAL:

Photocell for height control upper platform

A	TYPE	Q.ty	Torque Nm
SCREW	M5x20	5	5,5
WASHER	M5	4	/
NUT	M5 selflocking	2	/

B	TYPE	Q.ty	Torque Nm
SCREW	M4x12	1	2,78
WASHER	M4	1	/
NUT	M4 selflocking	1	/

C	TYPE	Q.ty	Torque Nm
SCREW	M4x30	2	2,78
WASHER	M4	2	/
NUT	M4 selflocking	2	/

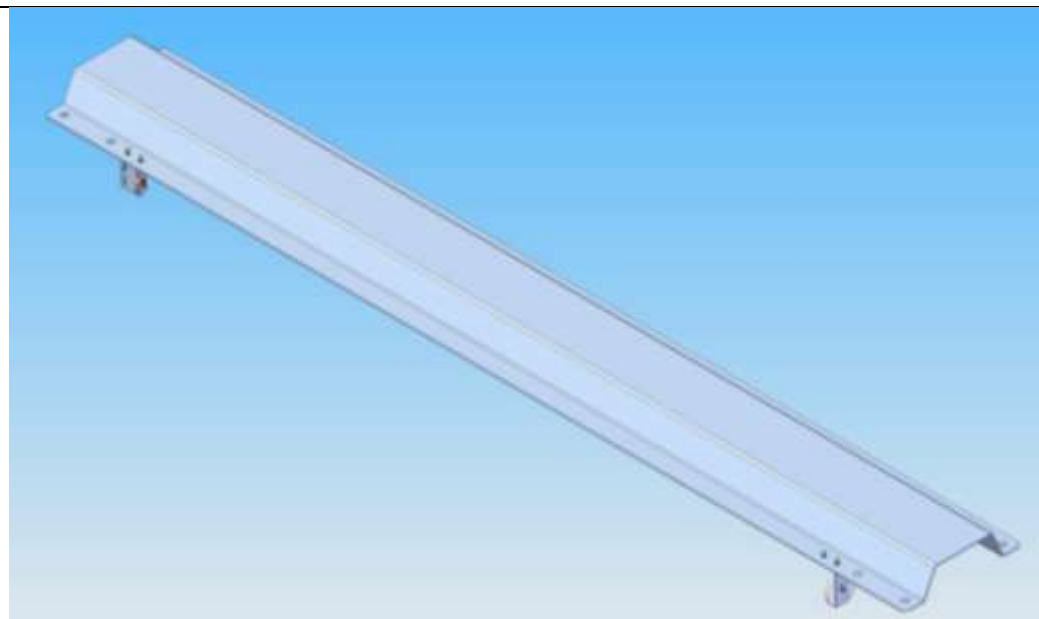

33

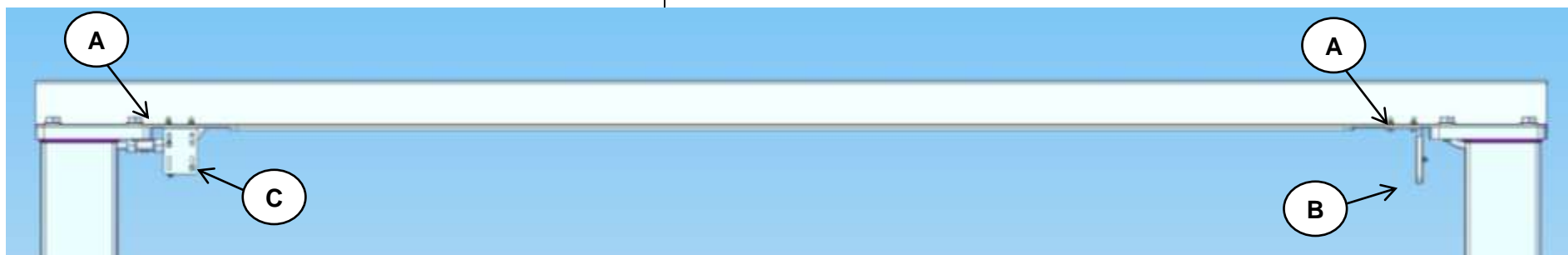

10. Check before using

The first time the lift started up it is essential to:

- Clean and start up the system
- Check that the limit switches are functioning properly.
- Check the position of the limit switches to stop at the desired floors
- Check floor leveling of the platforms and stopping precision
- Check floor levelling and stopping precision
- Check that the floor push-buttons are functioning properly
- Check installation of warning signs - see chapter on Safety in the User's Manual
- Check that documentation is on hand - see chapter on Safety in the User's Manual

After having performed all adjustments and controls, run a lift test running it all the way up and down; this operation serves to check that the entire machine is functioning properly and that there are no hydraulic system leaks.

10.1. *Final testing*

Static and dynamic overload tests are performed at the manufacturer's premises.

The user can run checks with the rated load (a $\pm 10\%$ variation due maximum valve calibration is admissible) and with the loads distributed as indicated in the paragraph on *Load conditions* in the User's Manual.

10.2. *Handing over the platform*

The platform is handed over after having completed all the checks indicated in the start-up report

11. Dismantling the machine

Before dismantling the machine, contact OMER S.p.A. technical services.

If parts or the entire machine need to be dismantled, remember:

- 1) bring the platform to the lowest floor and take the machine OUT OF SERVICE;
- 2) carefully empty all oil from the cylinders and ducts, preventing spillage in the area. The oil recovered must be disposed of in compliance with current law;
- 3) dismantle the machine following the operations indicated in the chapter on *"Positioning the lift"* but in the opposite order
- 4) sort the material derived from demolition by type and/or class to facilitate disposal and any reuse

