

HOFMANN® 

geodyna® **7340P**



CAR WHEEL BALANCER

ENGINEERING UNLEASHED™

geodyna® 7340P

CAR WHEEL BALANCER WITH GEOTOUCH™ DISPLAY

The geodyna® 7340P wheel balancer combines an intuitive interface with efficiency-boosting functionalities, allowing high-volume shops to accomplish more tasks in less time. Limiting workflow disruptions while optimizing productivity can pose a challenge to tire shops that handle substantial workloads, yet this balancer rises to the occasion. Featuring an integrated weight tray and ergonomically designed touchscreen monitor with user-friendly interface, operations are streamlined for enhanced ease of use. With a unique software that has the ability to accommodate two user configurations, technicians can seamlessly alternate between balancing different sets of wheels. A suite of productivity-enhancing features, such as smartSonar™, easyWeight™, easyALU™, and Power Clamp™, enables users to navigate the wheel balancing process with heightened speed and unwavering precision. The geodyna® 7340P wheel balancer from Hofmann® is a valuable investment for shops in search of premium balancing results to grow both productivity and revenue.



EASYWEIGHT™

Streamlining weight placement, this precision-focused system eliminates guesswork. It employs a laser to precisely indicate the exact location for weight application, ensuring meticulous balancing and accurate results.



POWER CLAMP™

Utilizing advanced electromechanical technology, this balancer incorporates a power clamping device that consistently and reliably secures the wheel with a constant force. This ensures exceptional accuracy and repeatable results every time.

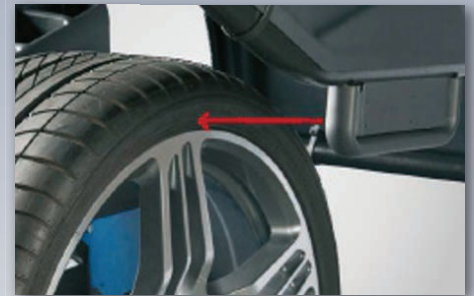

SMARTSONAR™

This intelligent system utilizes sonar sensors to automatically detect the rim width, eliminating the need for manual input and reducing the possibility of errors. By streamlining the process, it enhances efficiency and accuracy.

THE ULTIMATE IN PRODUCTIVITY AND PERFORMANCE



INTEGRATED TOUCHSCREEN MONITOR

Monitor seamlessly integrated with the weight tray to enhance ergonomics and offer a convenient wheel balancing experience.



SEMI-AUTOMATIC DATA ENTRY

Equipped with a user-friendly gauge arm, this system facilitates data entry with easyALU™ assisted rim measurement technology. Technicians simply touch the rim with the gauge arm, and the system automatically enters the rim dimensions and selects the appropriate weight-balancing mode.

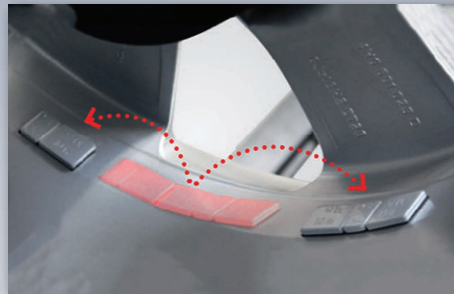

SPLIT WEIGHT MODE

This feature ensures accurate balancing and discreet weight concealment behind spokes, maintaining the wheel's aesthetic appeal and visual presentation.



STOP IN POSITION

By simply touching the screen, users can prompt the system to automatically rotate the wheel to the precise position for weight application. This convenient feature streamlines the process and enhances operational efficiency.

REPORT

Easily generate reports on the local network (additional hardware required) or save as PDFs on a flash drive, facilitating convenient sharing of detailed information with customers for documentation or reference.

EZ-COLLETS

The EZ-Collets mobile app helps technicians find the right collet, flange plate or speed plate for their job by selecting the vehicle. They can then compare and assess the available tools' benefits.



MULTIPLE USERS

Two users can operate the balancer simultaneously and quickly recall their rim dimensions.



QUICKBAL™

Engineered for optimal performance, this feature intelligently adjusts the number of revolutions according to each wheel's specifications. Operating at maximum speed, it effectively reduces cycle time, delivering swift and efficient results.



RIM LIGHTING

Equipped with a powerful LED lighting system, this balancer ensures optimal illumination of the rim. This feature aids in rim cleaning and significantly assists in the precise positioning of weights, ensuring a seamless balancing process.

TECHNICAL SPECIFICATIONS

Part Number	EEWB774APC
Semi-Automatic Rim Diameter Range	8" - 25" 20 - 63.5cm
Semi-Automatic Width Range	3" - 15" 7.6 - 38cm
Manual Rim Diameter Range	8" - 32" 20 - 81.2cm
Manual Rim Width Range	1" - 20" 2.5 - 50.8cm
Max Wheel Diameter	42" 106.6cm
Max Wheel Weight	154 lbs. 70 kg
Power Supply	115V 1Ph 60Hz
Dimensions HxWxL	71"x 60"x 53" 180x152x135cm

STANDARD ACCESSORIES

- Four Cone Set
- Weight Pliers
- Rim Width Caliper
- Weight Remover Tool

OPTIONAL ACCESSORIES

- Light Truck Cone Kit (8100068)
- 9 Collet Set (EAK0375G07A)
- Speed Plate Kit with Collets and Storage Stand (EAK0309J33C)
- Storage Stand (EAK0309J67A)



US 800.251.4500

CANADA 800.267.2185



Snap-on® Total Shop Solutions offers a wide range of garage equipment solutions for workshops, garages, car dealers and tire shops, thanks to the specific solutions provided by its portfolio of premium brands. Hofmann® is a brand of TSS and is committed to product innovation and improvement. Therefore, specifications listed in this sell sheet may change without notice. ©2023 Snap-on Incorporated. Hofmann® is a trademark, registered in the United States and other countries, of Snap-on Incorporated. All rights reserved. All other marks are marks of their respective holders. sswb23003 10/2023

HOFMANN

HOFMANN-EQUIPMENT.COM